

02.A

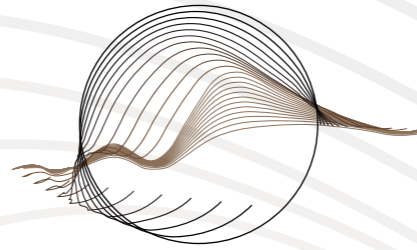

CATALISTS_bo

Re-Contextualization & Re-Valorization of the Memory Gap

SYNAPTIC URBANITY: A MULTI SCALE PROPOSAL FOR FIERA DISTRICT
NEXT TO MASTERS: CENTER OF ARCHITECTURE

instructors:

*Prof. Dr. Aysen Savas
Prof. Dr. Arzu Sorguc
Inst. Tolga Hazan
Inst. Onat Oktem*

date:

*September'17
June'18*

location:

*Fiera District
Bologna
ITALY*

Incoherent contextualization of urban development, like in many other cities, is the greatest problem that the Italian city, Bologna faces in the 21st century. Duality between the 14th century's culture, which lies in harmony with the permanent urban structure and the current programmatic complexity of the city, and the outcomes of the 19th century's rigid modernism create a great dilemma. This duality limits the dissemination of the "collective memory" of the city and locates it into the ancient urban center. Thus, the goal of this project is to collect the collective memory from the existing structures and transform it to the 21st century with the help of with a contemporary, parametric design method.

A problematic site in Bologna is the Fair district, which endures as an alienated city part due to the 18th century's zoning decisions. The proposal aims the revalorization of the district by means of transforming the existing architectural culture or memory from the historic city center. Also, this method will introduce a new way of exhibiting, which will eventually change the current fair understanding. As the implementation in site is the process of decoding the memory that is collected from urban elements and whole composition of urban "nodes" in the center; the node or memory or culture could be revealed in different parts of the city for future urban treatments leading to an urban coherence.

Project proposes to Fiera District is existing collective memory, culture, structure that will be the new interpretation. New urban structure that juxtaposed with the existing site dynamics allows people to embrace like in the urban center. This permanent structure has its own programmatic function layering which could chance permanently.



SYNAPTIC URBANITY :

BOLOGNA

FIERA DISTRICT

COLLECTIVE MEMORY

URBAN CATALISTS & NODE



FIERA DISTRICT
AS A GAP

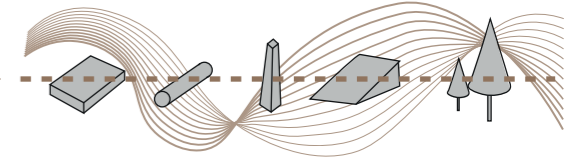

_ANALYSIS & DECODING URBAN CATALISTS

_POINT RELATIONS

_URBAN COMPOSITION

_REPRETRASING THE URBAN NODE & CATALISTS

PIAZZA

MAP

PLAN

SECTION

ABSTRACTION

GREEN

MAP

PLAN

SECTION

ABSTRACTION

PORTICO

MAP

PLAN

SECTION

ABSTRACTION

STAIR

MAP

PLAN

SECTION

ABSTRACTION

TOWER

MAP

PLAN

SECTION

ABSTRACTION

DETAILS

MAP

PLAN

SECTION

ABSTRACTION

VERDI

PORTA RAVENANA

GALVANI

CALDERENI

MAGGIORE

ZAMBONI

SANTA STEFANO

CAVOUR

TOWER

PIAZZA

PORTICO

GREEN

STAIR

DETAILS

BOLOGNA URBAN CENTER

EXISTING NODE

DISSOLVED NODE

REFOLDED NODE

FIERA DISTRICT

PARK
VERDI

ZAMBONI
PORTA RAVENANA
SANTA STEFANO

MAGGIORE
MINGHETTI
CALDERENI
GALVANI
CAVOUR

CALDERENI
VERDI
ZAMBONI
PORTA RAVENANA
MAGGIORE
SANTA STEFANO
CAVOUR

GALVANI
MINGHETTI

SANTA STEFANO

PORTA RAVENANA

MAGGIORE

GALVANI

REMAPPING THE NODE

CAVOUR

MINGHETTI

ZAMBONI

VERDI

URBAN TREATMENT :

RECONTEXTUALIZATION OF MEMORY GAP WITH REGENERATING CATALISTS

ALGORITHM GENERATION & IMPLEMENTATION ON
URBAN, DISTRICT, BUILDING, UNIT, FURNITURE SCALE

_REGENERATE OPERATIONS

DECODED CATALISTS
URBAN ELEMENTS

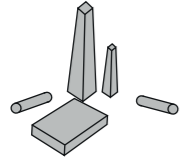

LINK | LOFT
ORIENTED SURFACES

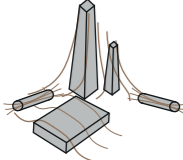

COVER
PERCEIVED URBAN VOLUME

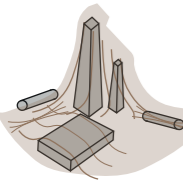

RESTRUCTURED
URBAN STRUCTURE

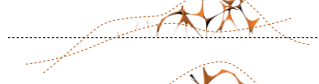
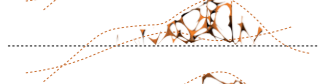
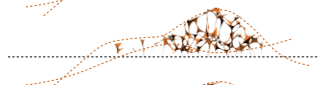
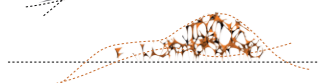
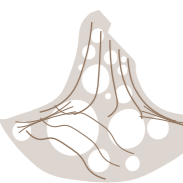

_CREATES A CONTINUOUS EXHIBITION PATH urban scale

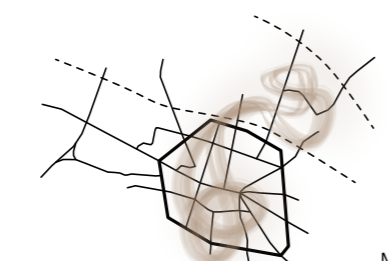
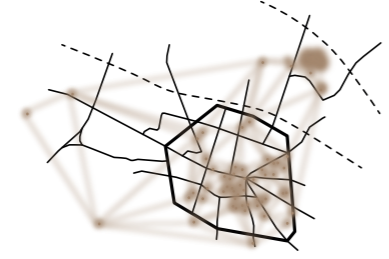
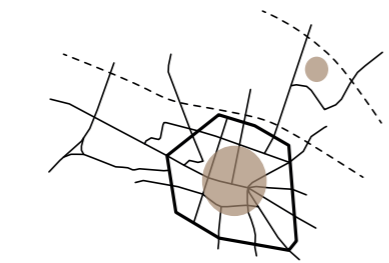
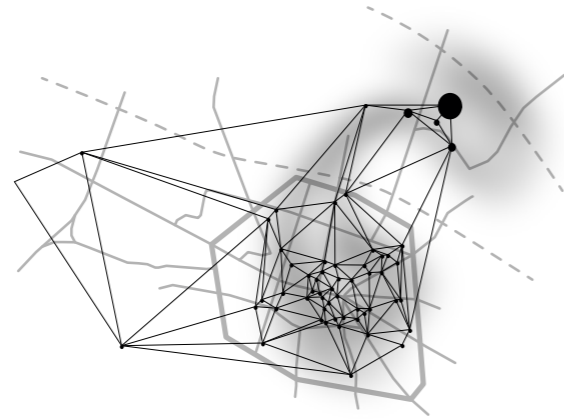

_NEXT TO MASTERS RELATIONS district scale

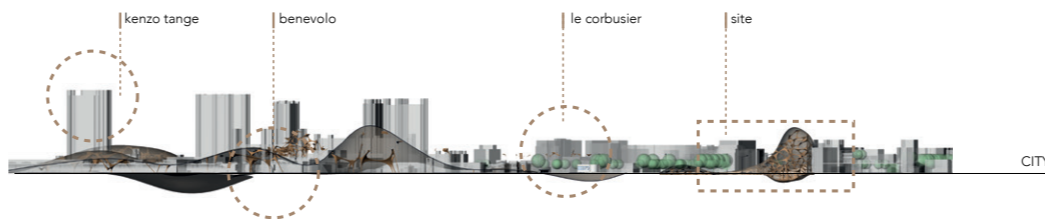
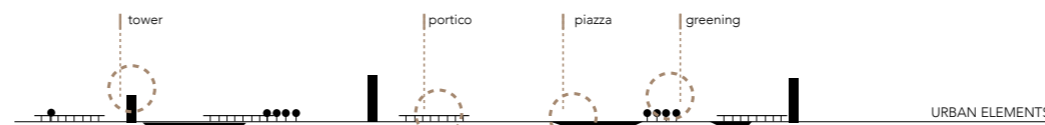
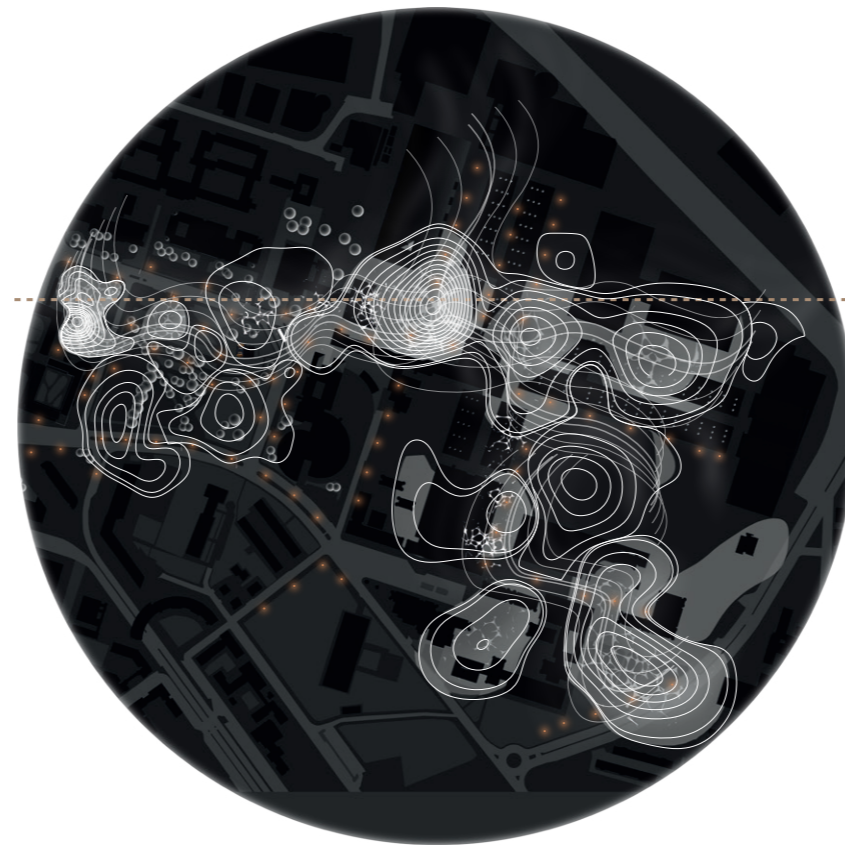

_UNIT CONFIGURATIONS building scale

STRUCTURE GENERATION

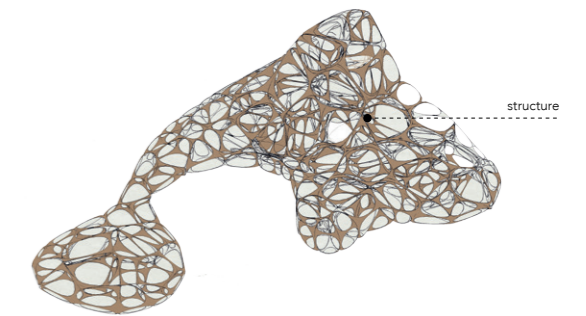
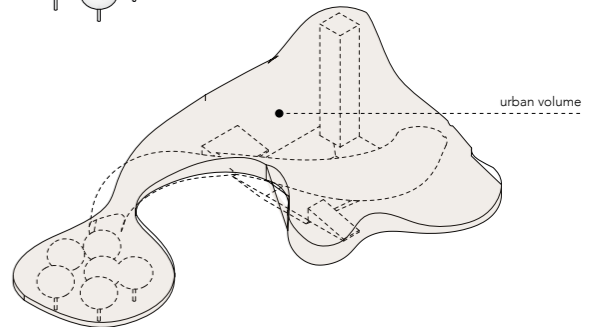
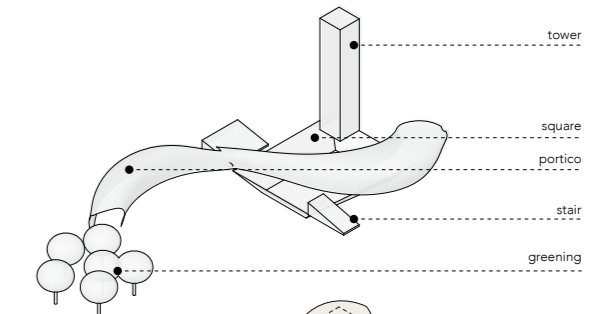

SPACE GENERATION

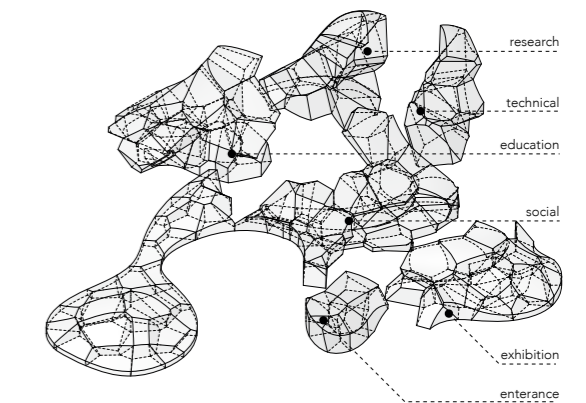

URBAN SCALE INTERVENTION

FROM

URBAN FURNITURE



TO

URBAN STRUCTURE

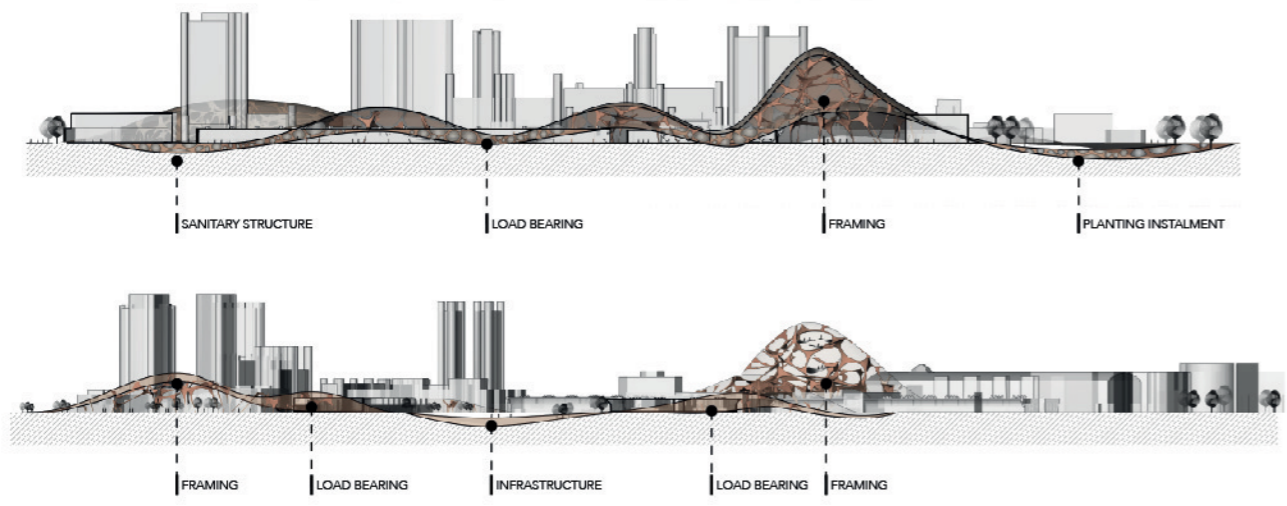
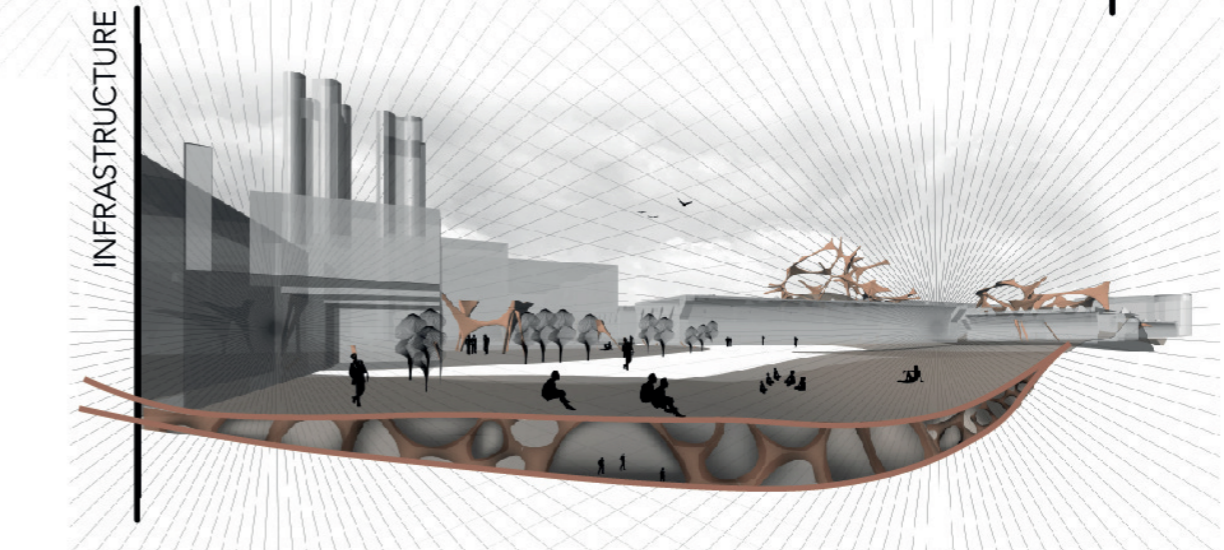
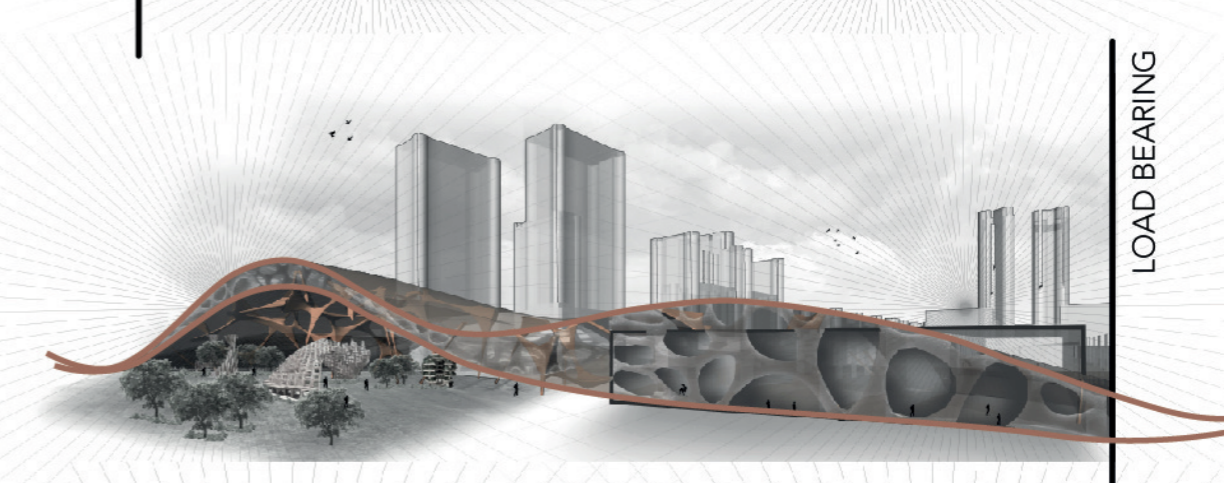
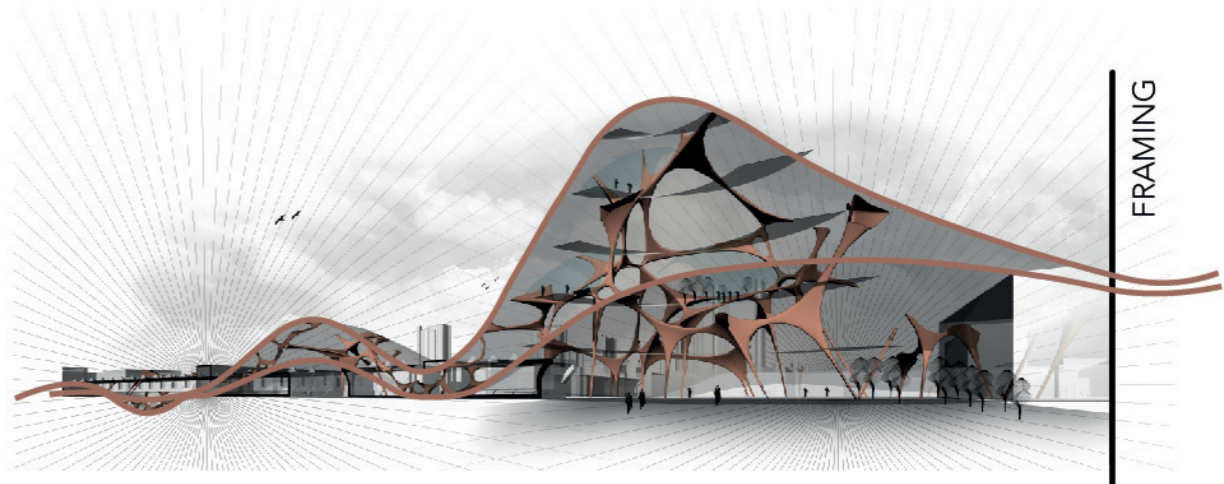
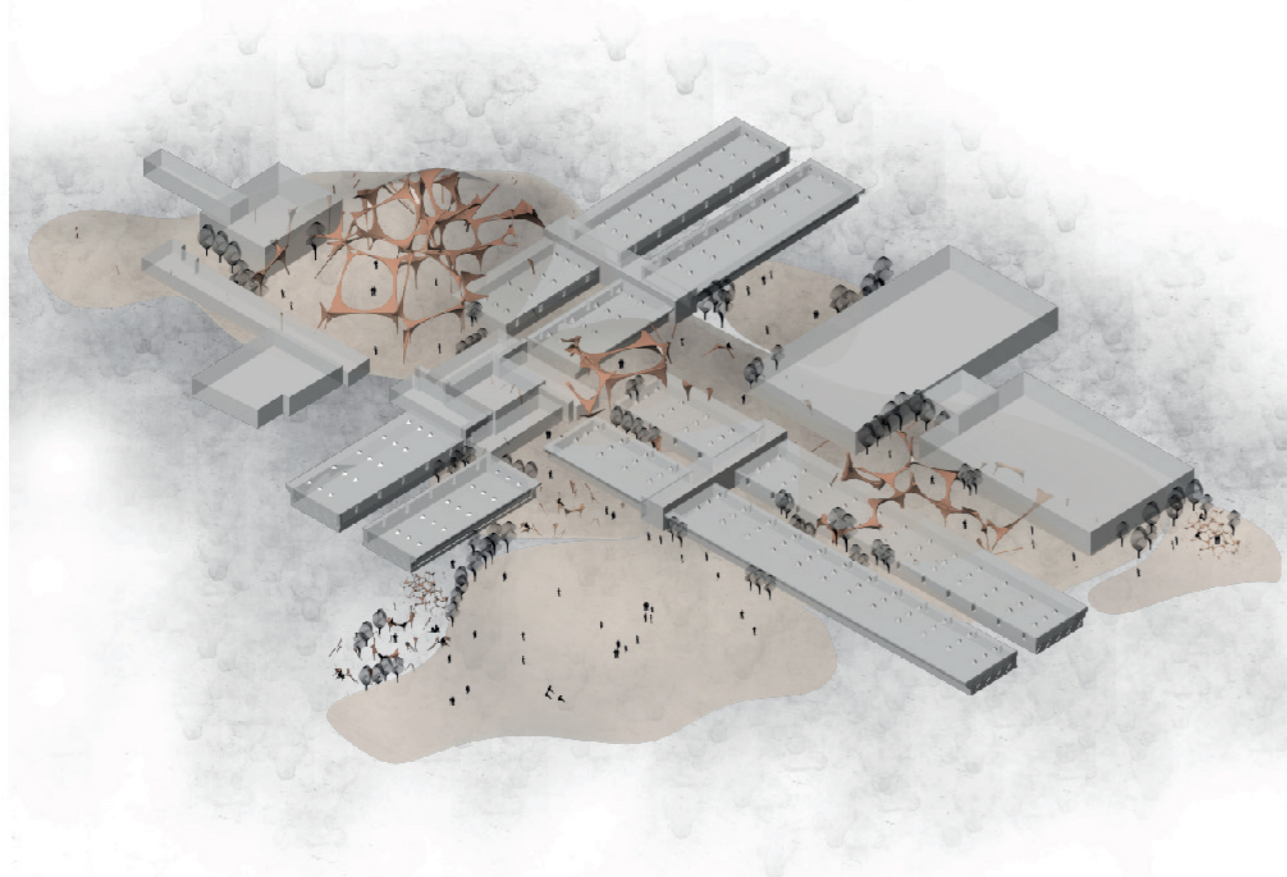

DISTRICT SCALE INTERVENTION

_SITE PLAN

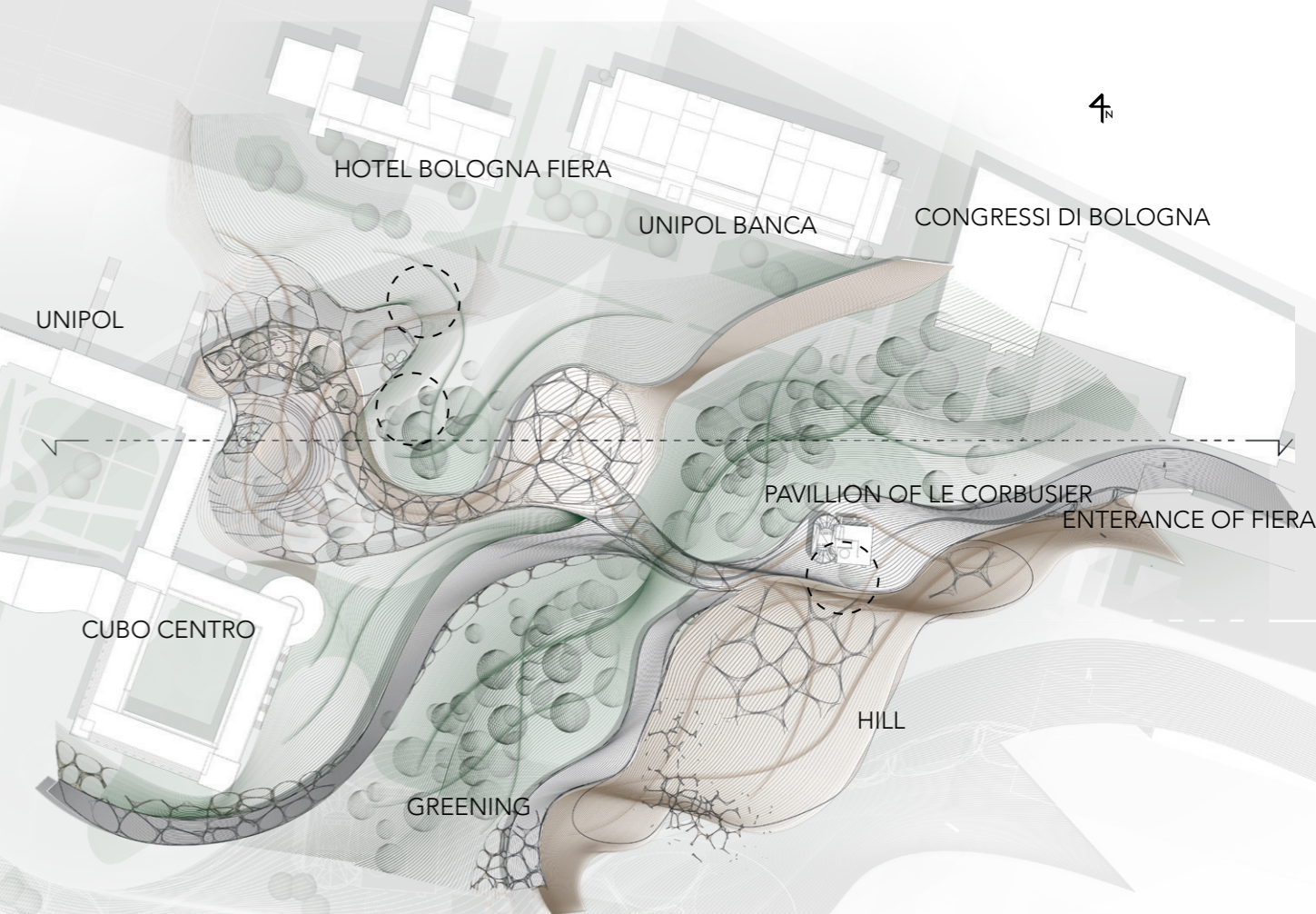

_PROCESS OF URBAN TREATMENT

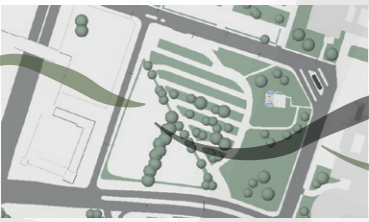

existing site

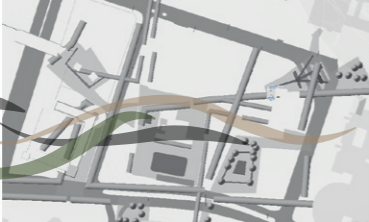

urban elements positioning

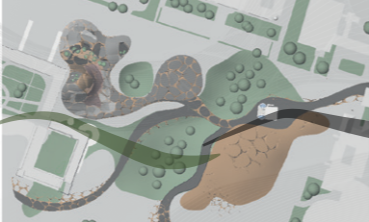

structured urban

_SITE SECTION

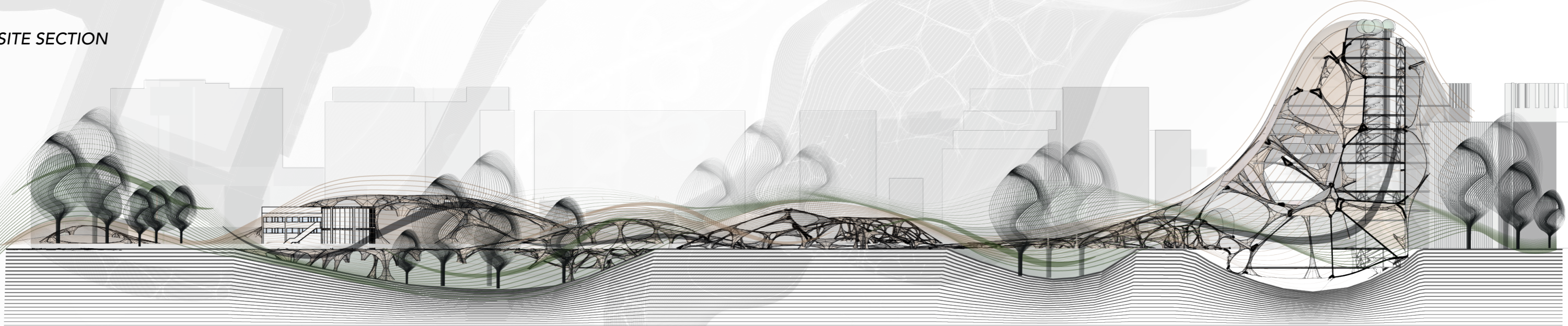

BUILDING SCALE INTERVENTION

_PLAN

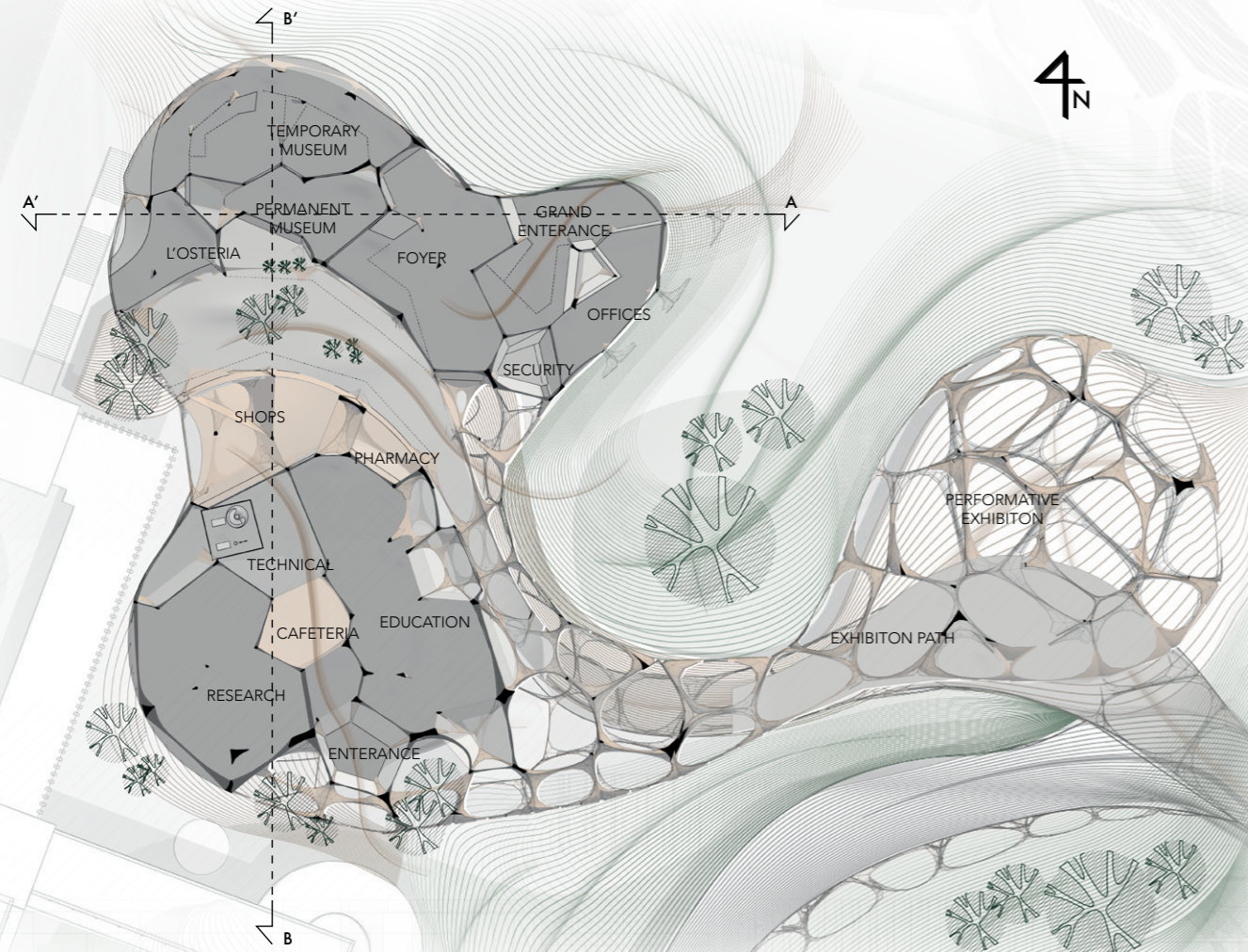

_SECTION AA'



_SECTION BB'

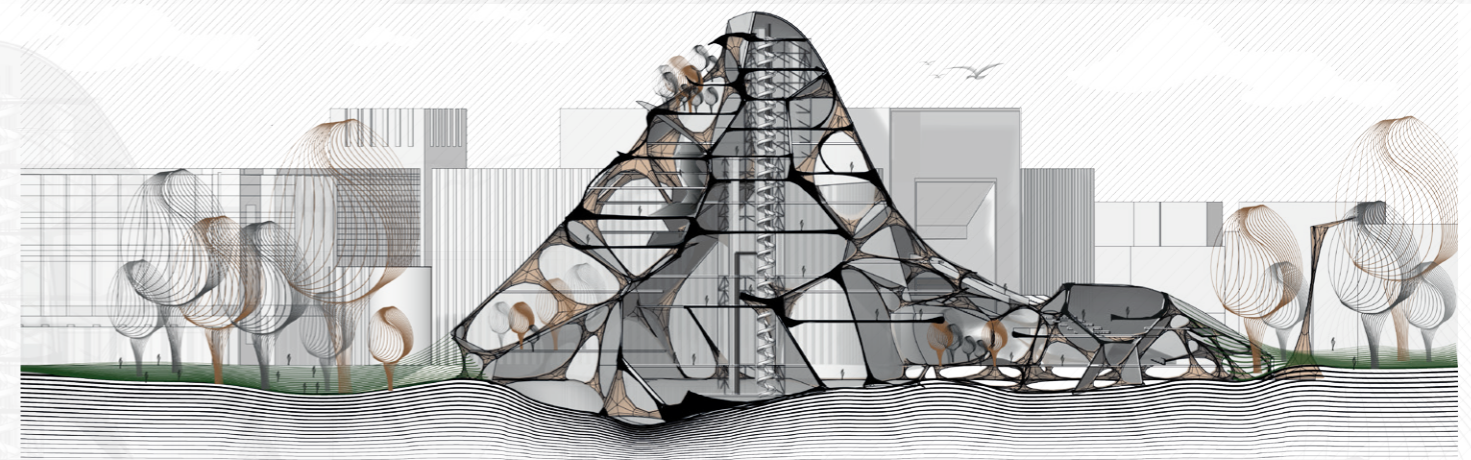

UNIT SCALE INTERVENTION

_INFORMATION INSTITUTE

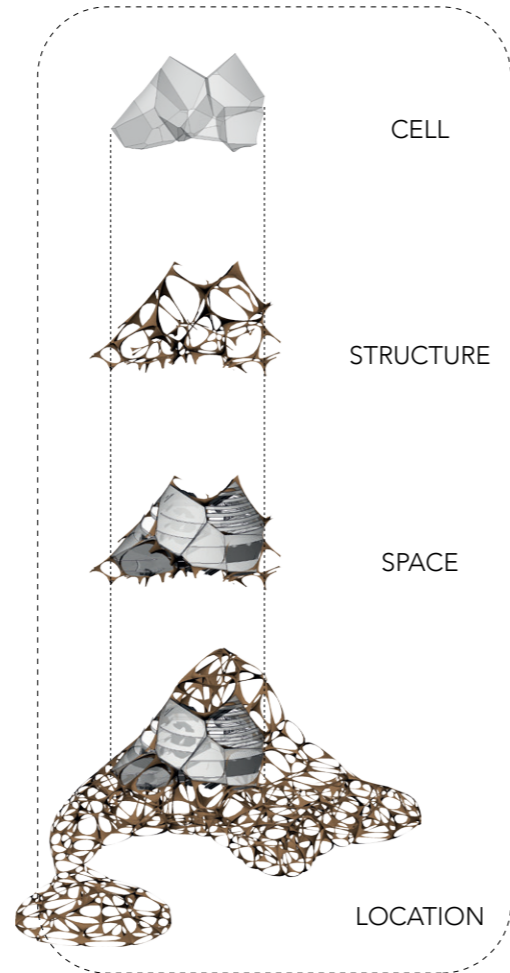
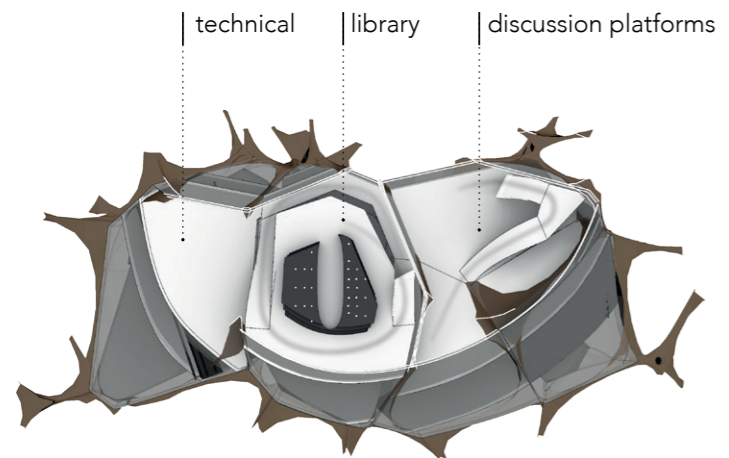
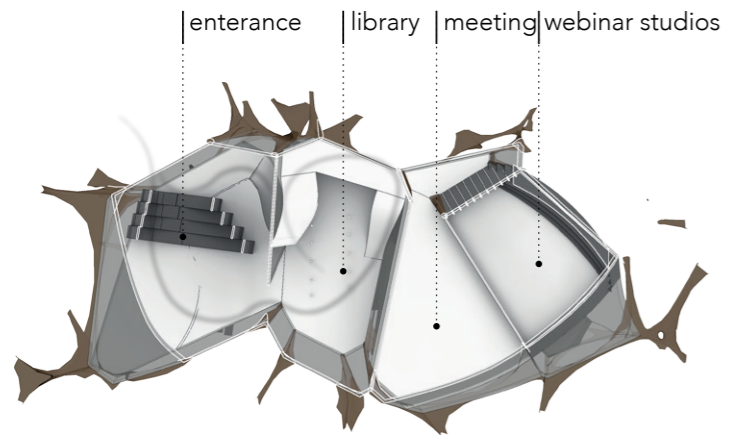
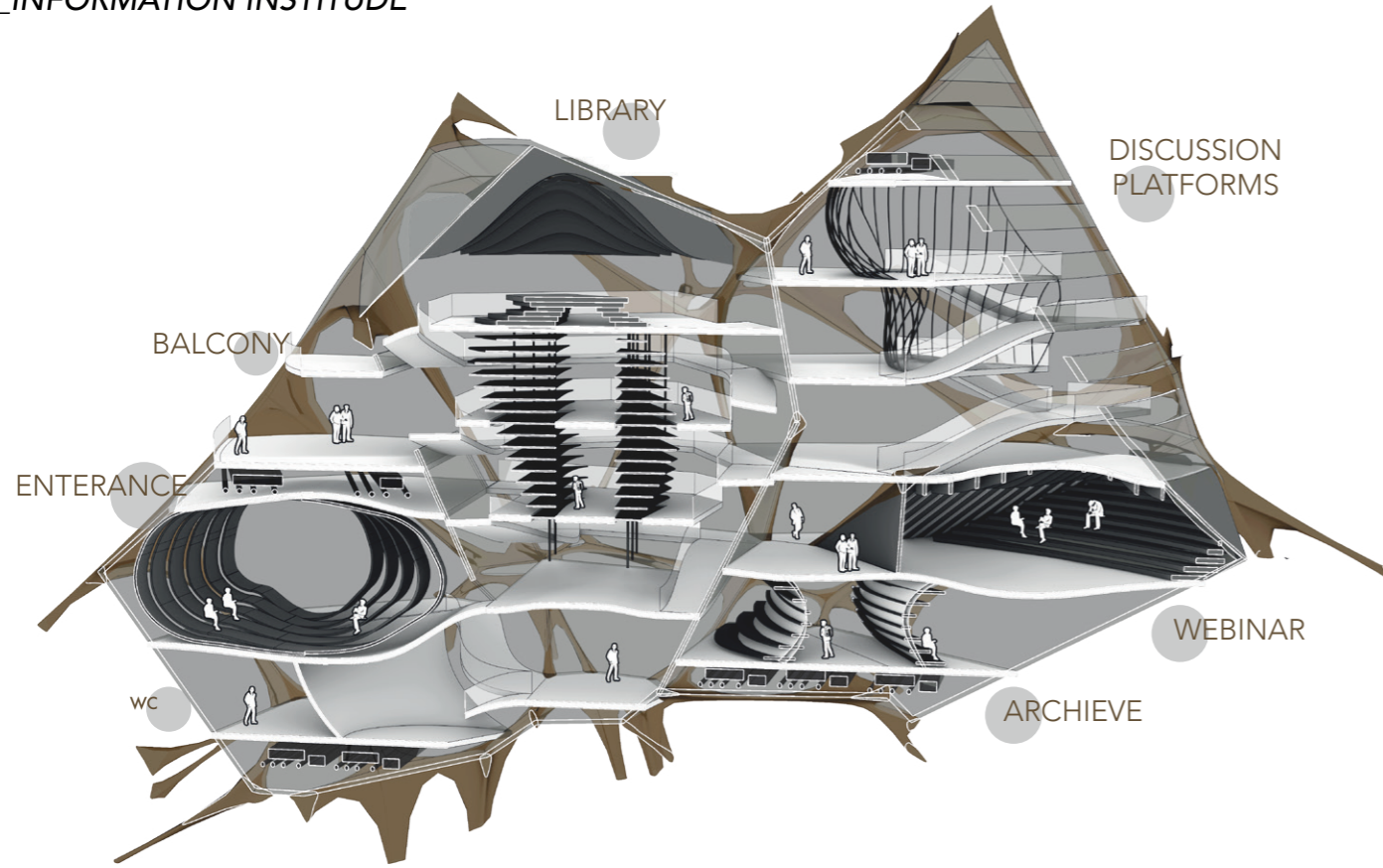

_INFRASTRUCTURE CORE

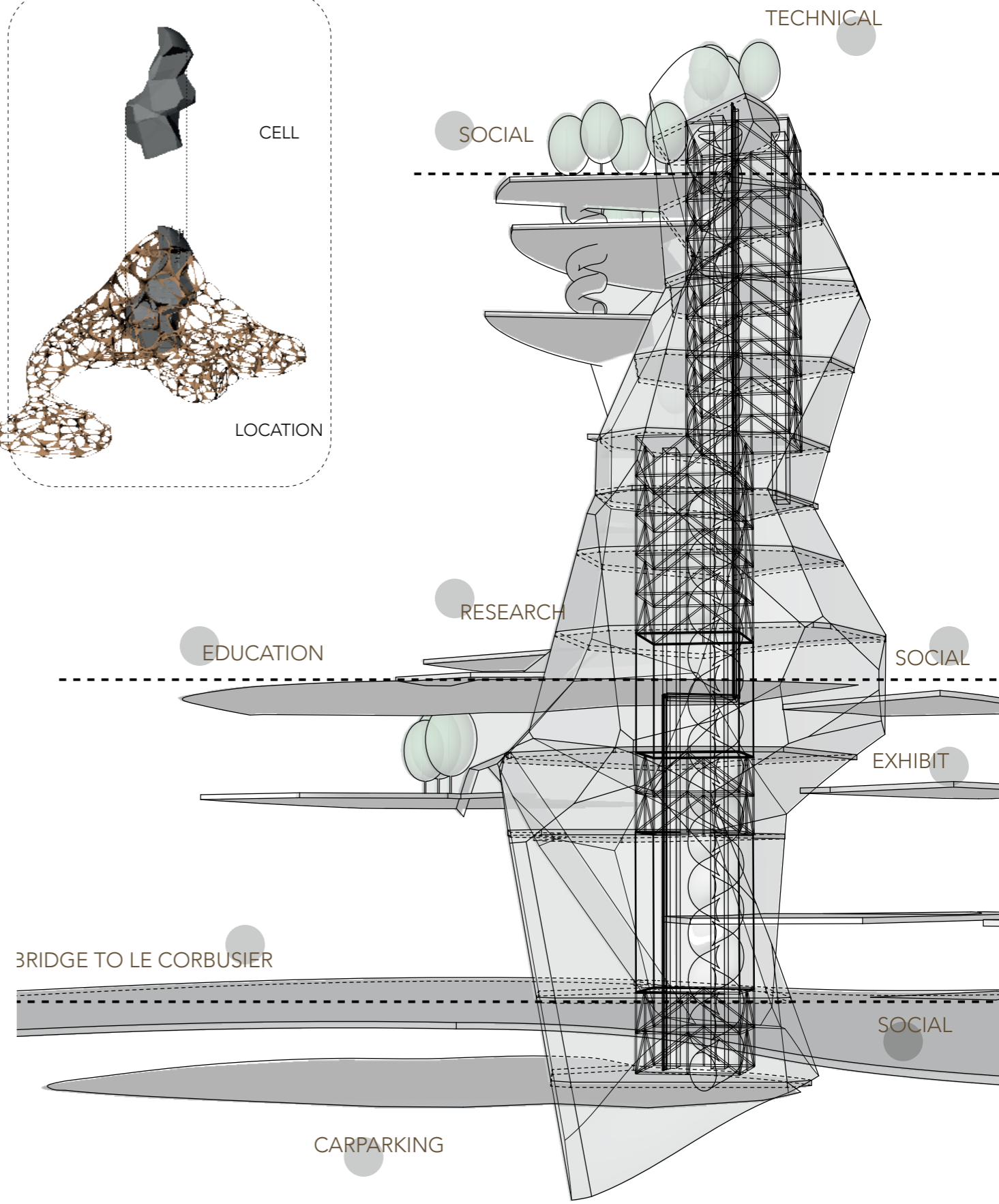
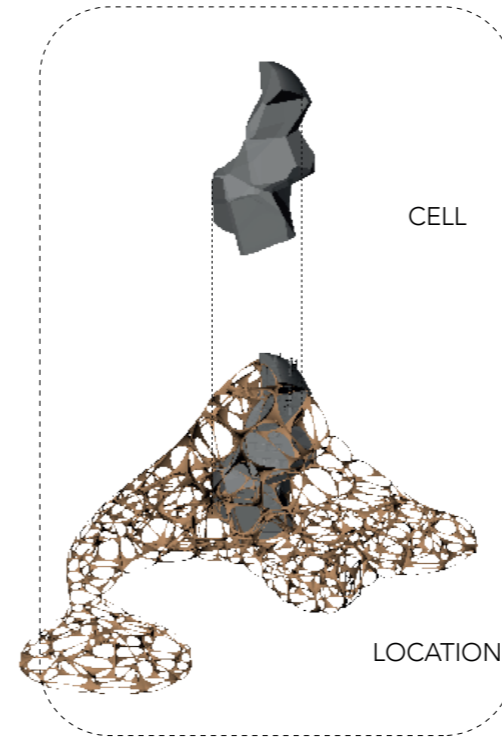

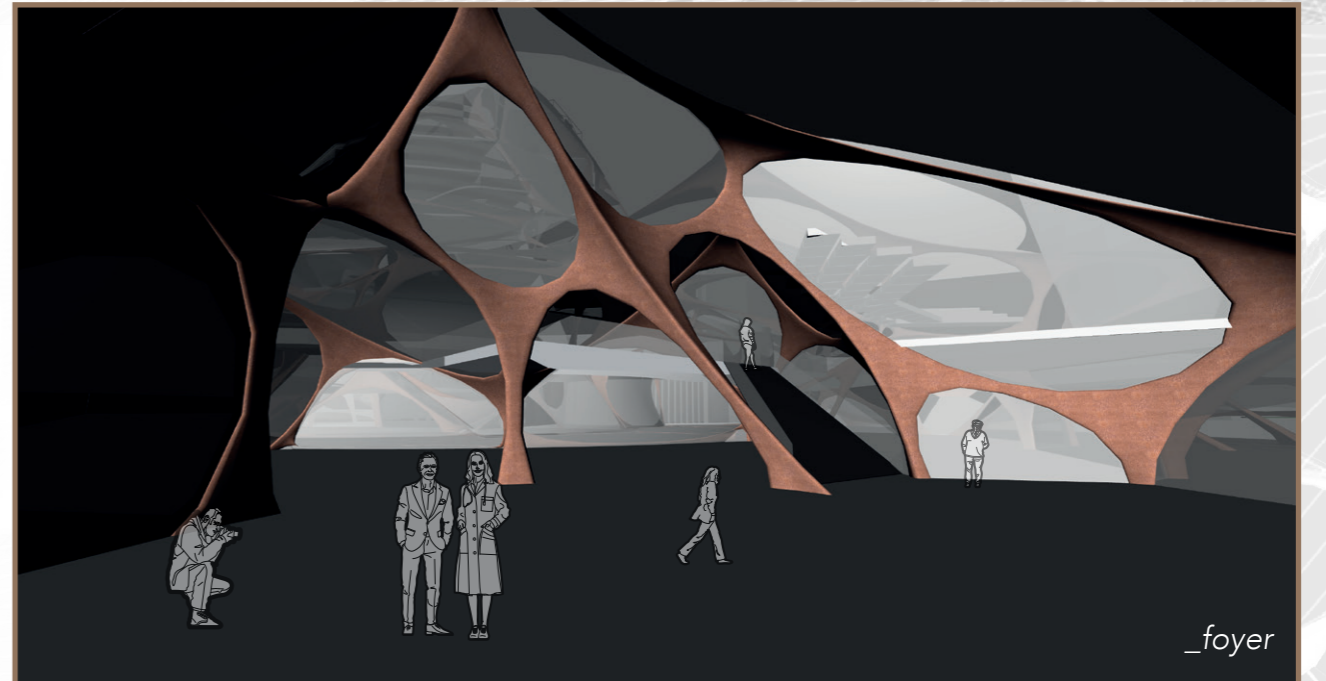
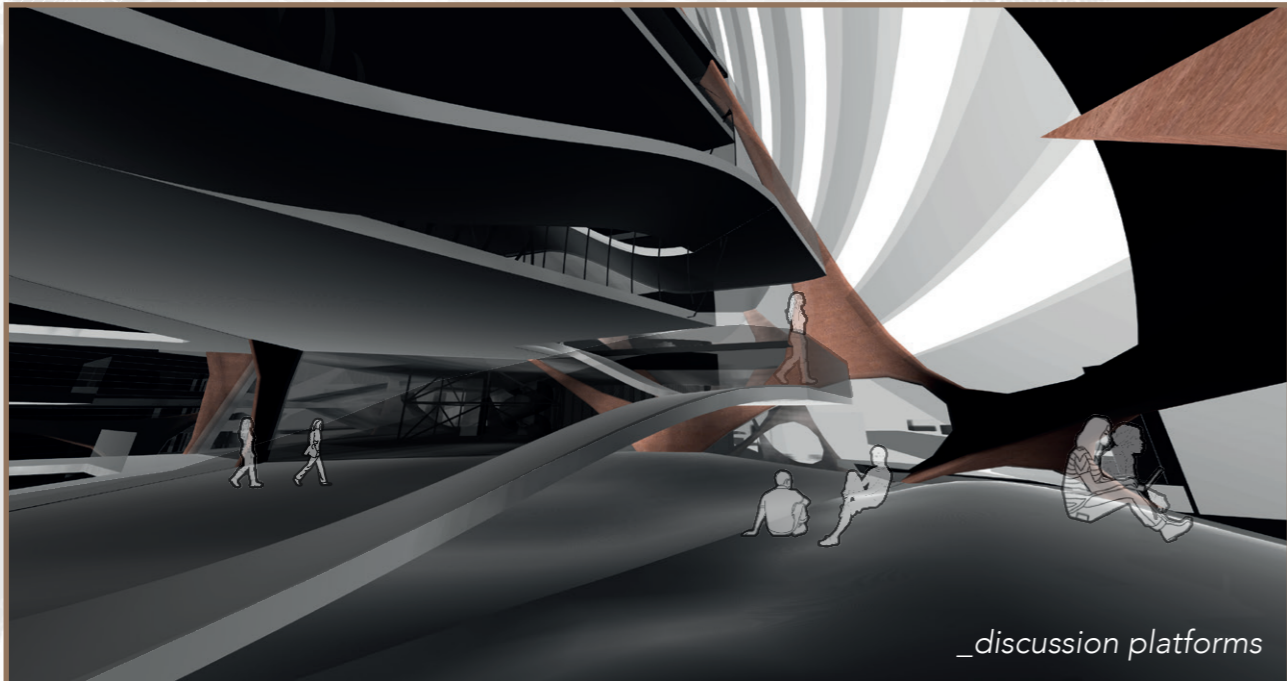
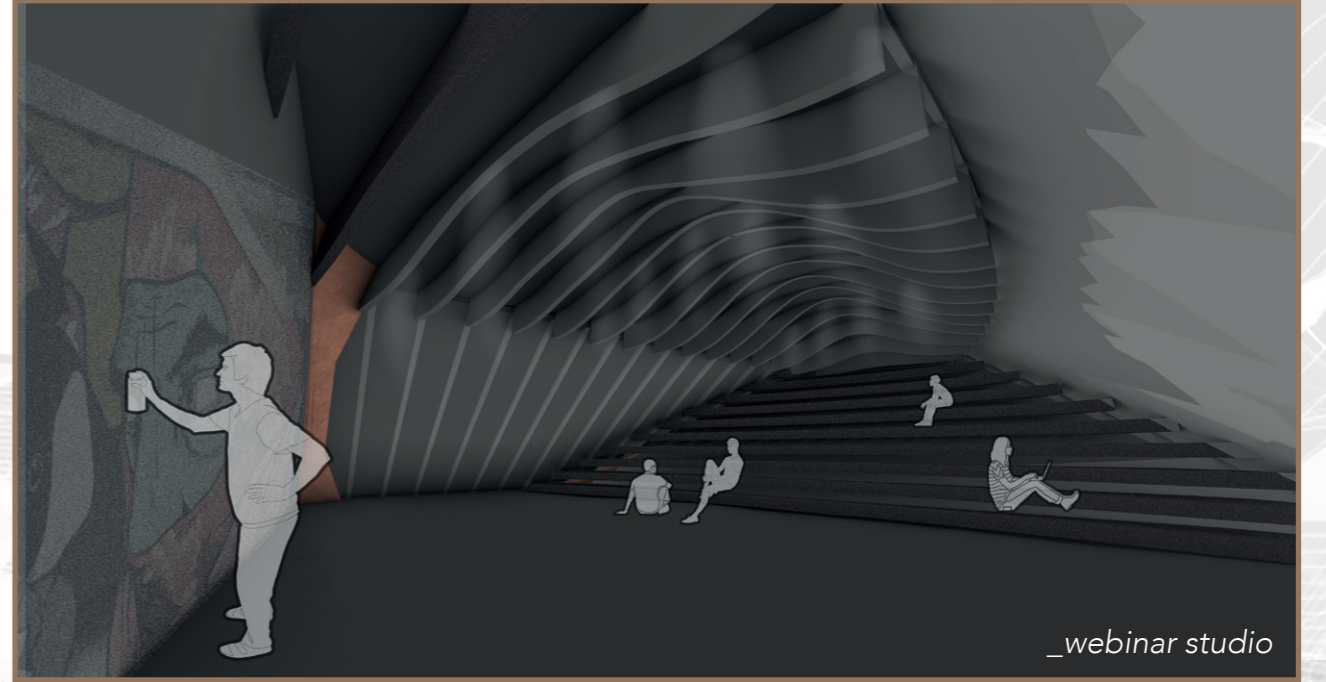
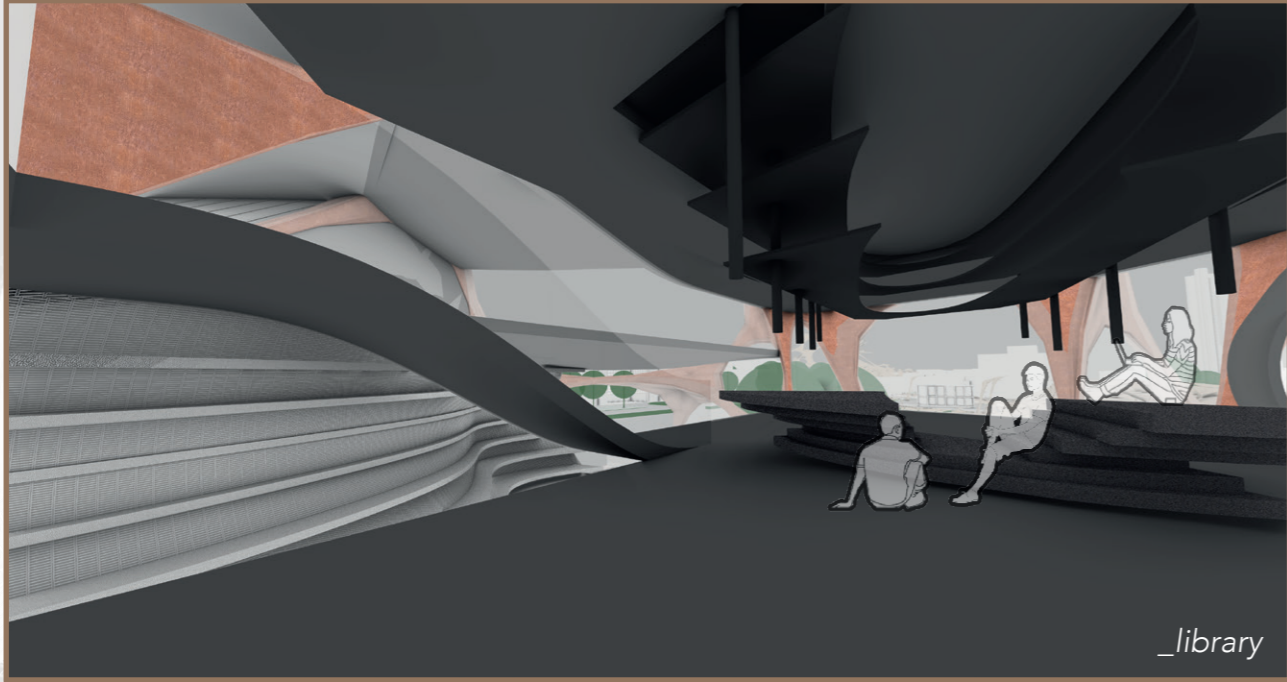

3D PRINT MODELLING

PROCESS

INSIDE

OUTSIDE

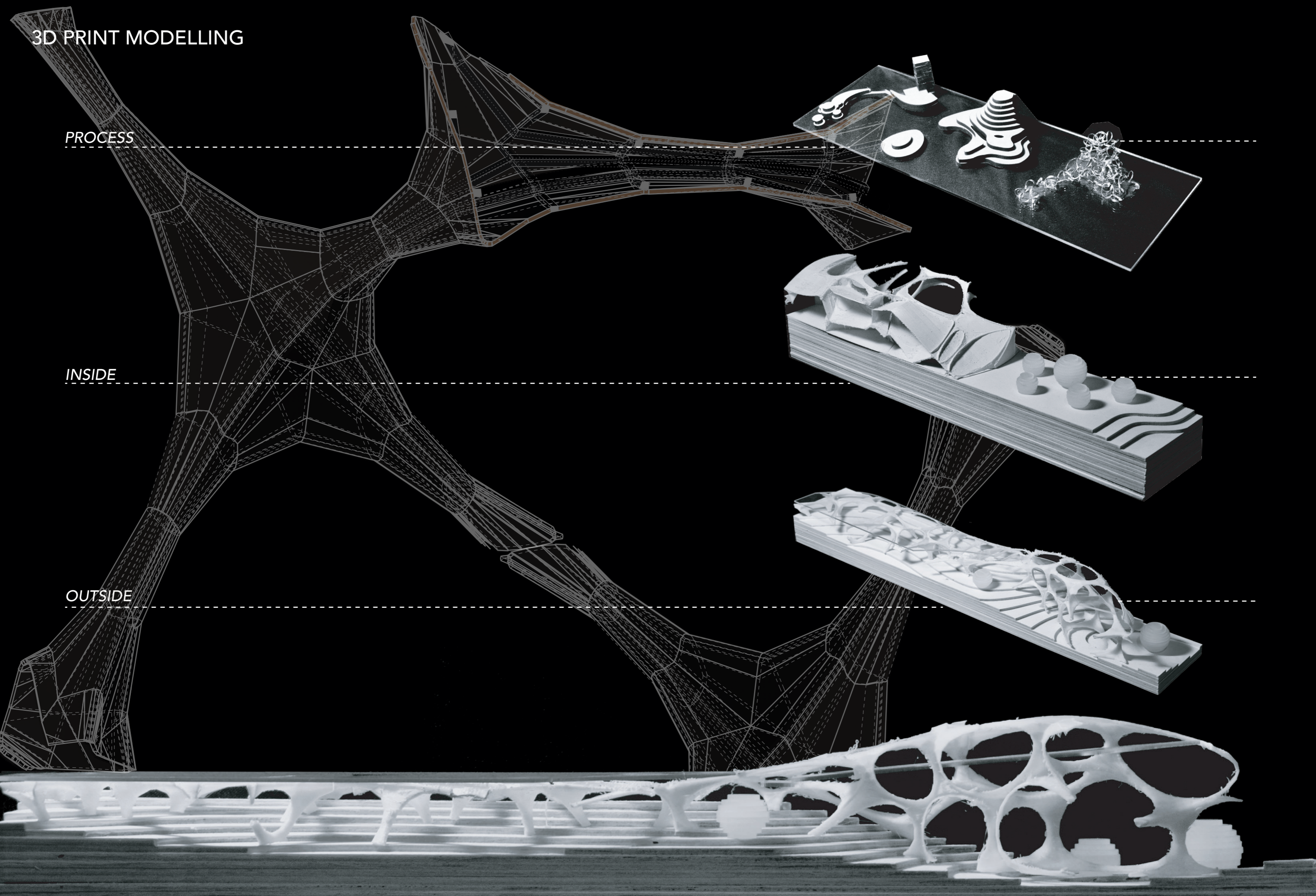

02.B

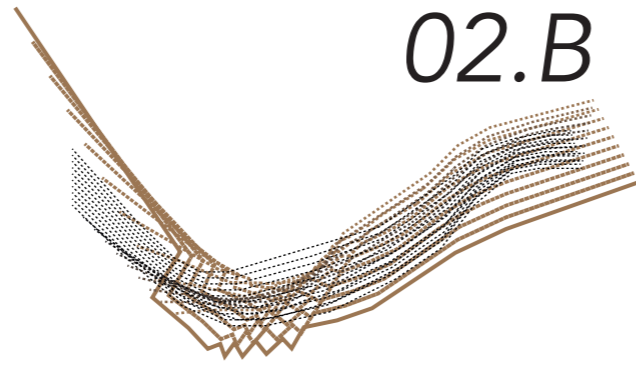

CORRIDOR

Invisible Urban Orientation

WHERE THE RIVER TURNS NORTH: PIERS AND HOUSE OF AMASYA

instructors:

*Prof. Dr. Aydan Balamir
Assit. Prof. Dr. Bekir Ay
Ins. Kakri Atabaş*

date:

*February'17
May'17*

location:

*City Center
Amasya
TURKEY*

Zoning of the life is prominent in the city center. Especially, commercial, historic, governmental and residential areas are differentiated. Due to commercial and historic zones located at the Southern part of the coast, people tend to gather at this part of the city. Present bridges are only passages which provide access between two sides and does not form a relationship with people and the city. The design focuses on diversifying public activity and interaction with nothern coast and with Yeşilirmak. Pier starts from the most dense area which is city square and directs people to the other side of the river. Along the pier, relation with the river is formed with different levels via ramps and rest areas are designed onto watercourse. At the water level, people can enjo Thus, people can approach and experience life on Yeşilirmak.

Intervention for this zone of the city should propose a collective and commercial lide. This refers to unificaitaion of activities, accomadation, commerce and socialization. At the same time, design should embrace both the stability, calmness of the city life and dynamism of urban. Understanding of street life has been lost considering character of the street life has been lost considering character of Amasya. Holistic design approach will find a solution to the isolation of zones of urban fabric. The main concept is break the housing block with socialized public urban corridor approach.

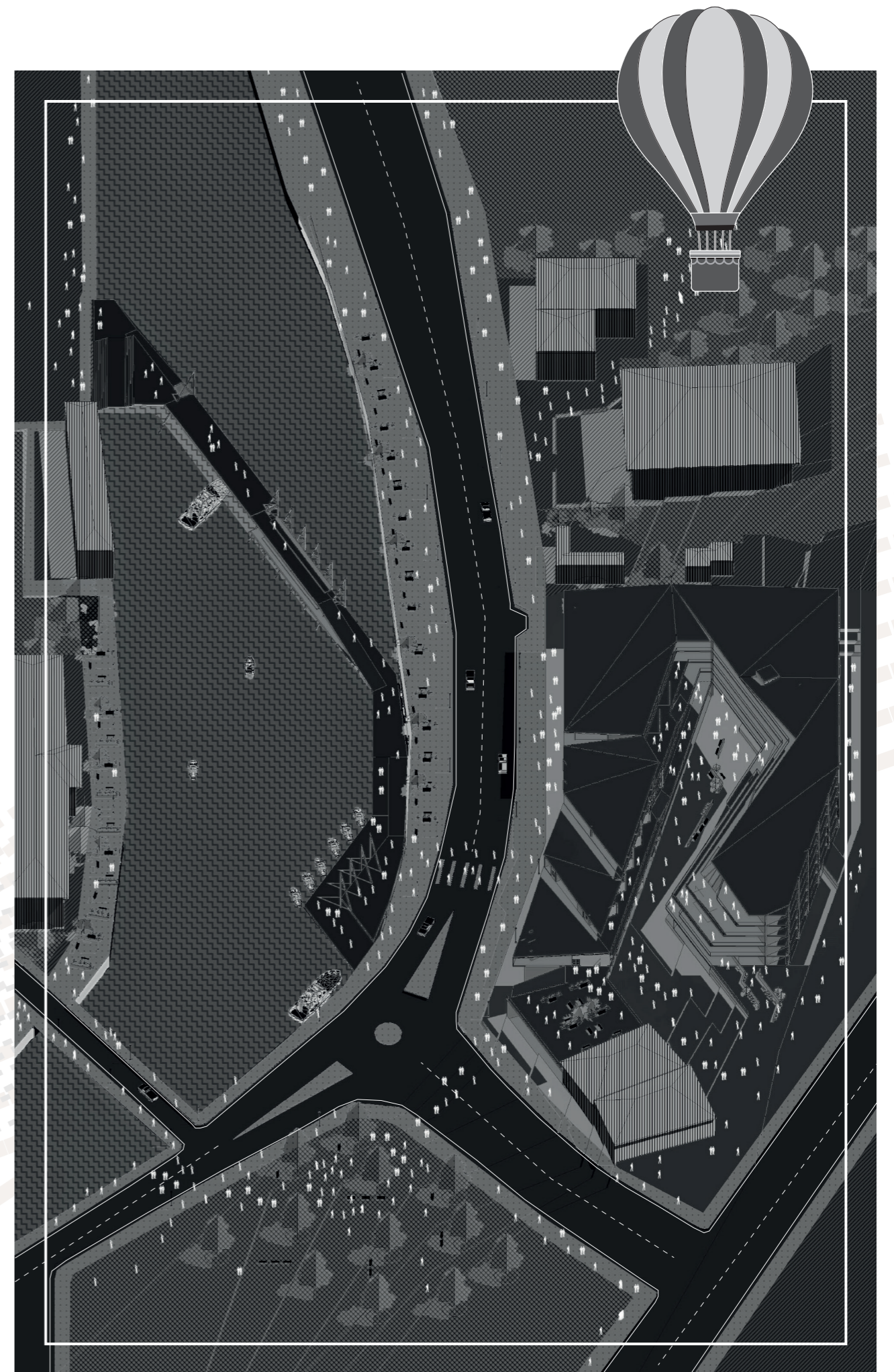

ANALYSIS

_ORIENTATION IN THE CITY

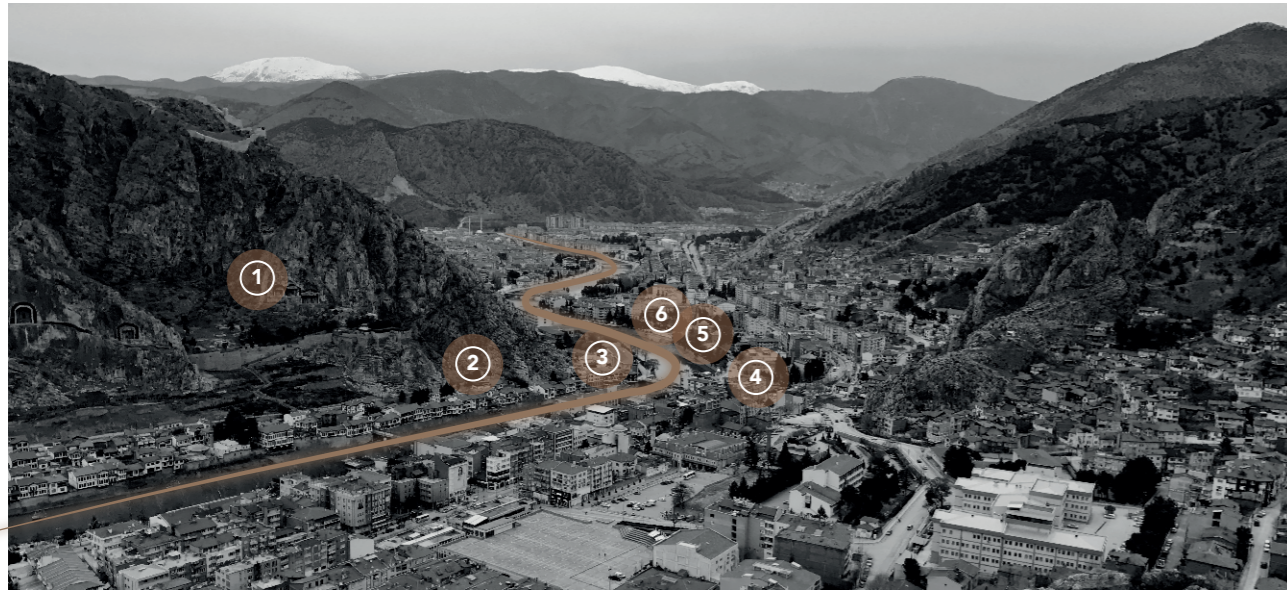

_rock tombs(1) _historical houses(2) _clock tower(3)

Existing Orientation

RIVER

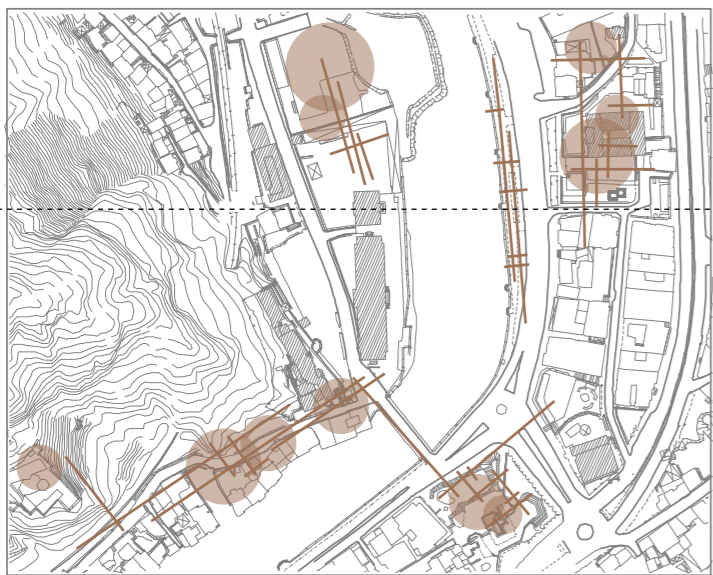

_square&statue(4) _museums(5) _historical mosques(6)

_DYNAMISM IN PLAN

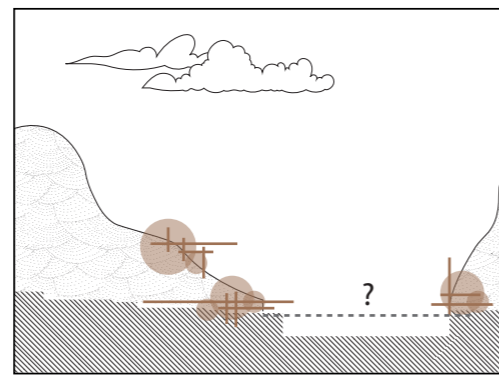

_DYNAMISM IN SECTION



-  dynamic spaces, movement possibilities
-  static spaces, points that people spend time

CONCEPT, PROCESS

_URBAN CORRIDOR

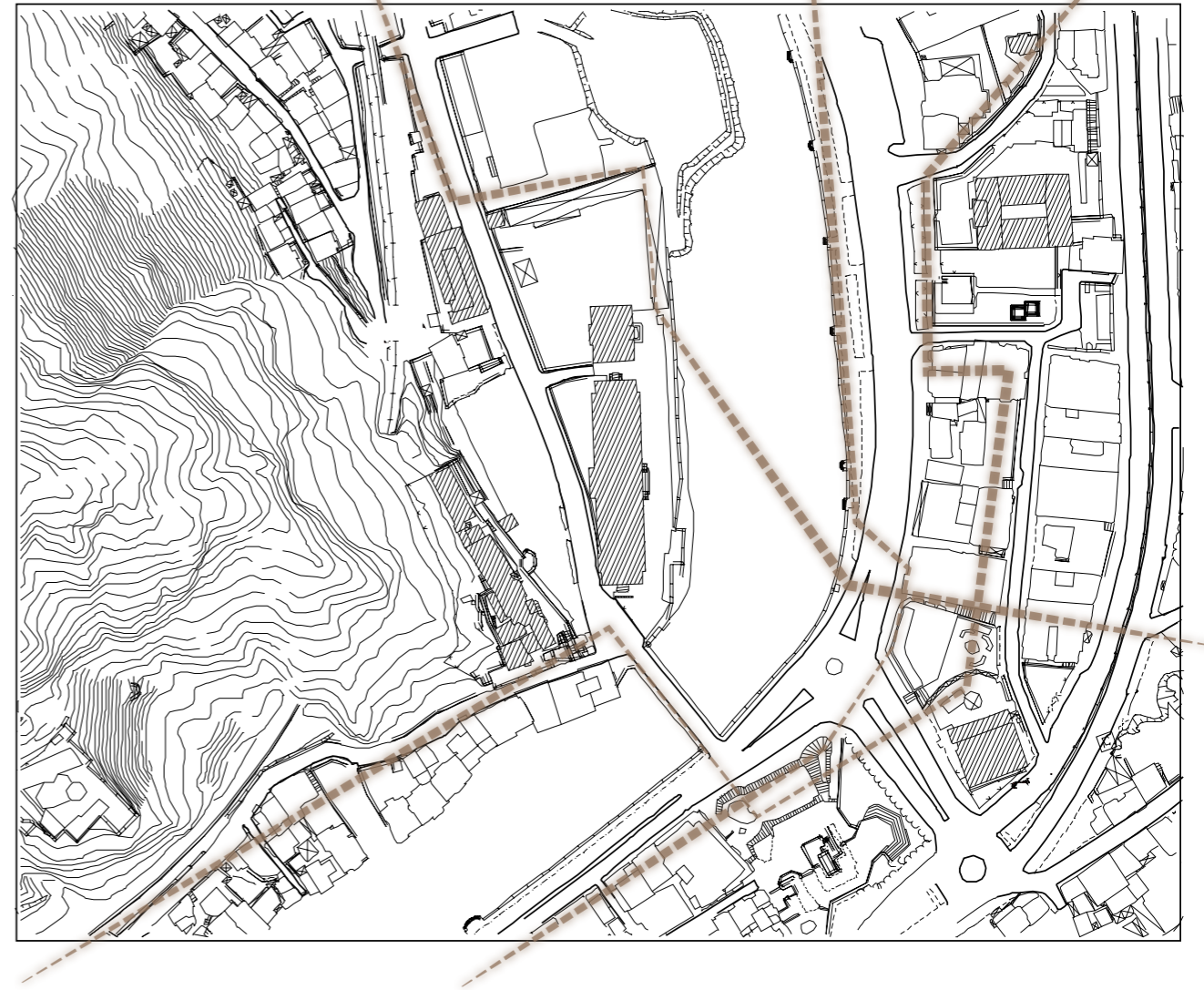

_ELEMENTS OF INVISIBLE ORIENTATION

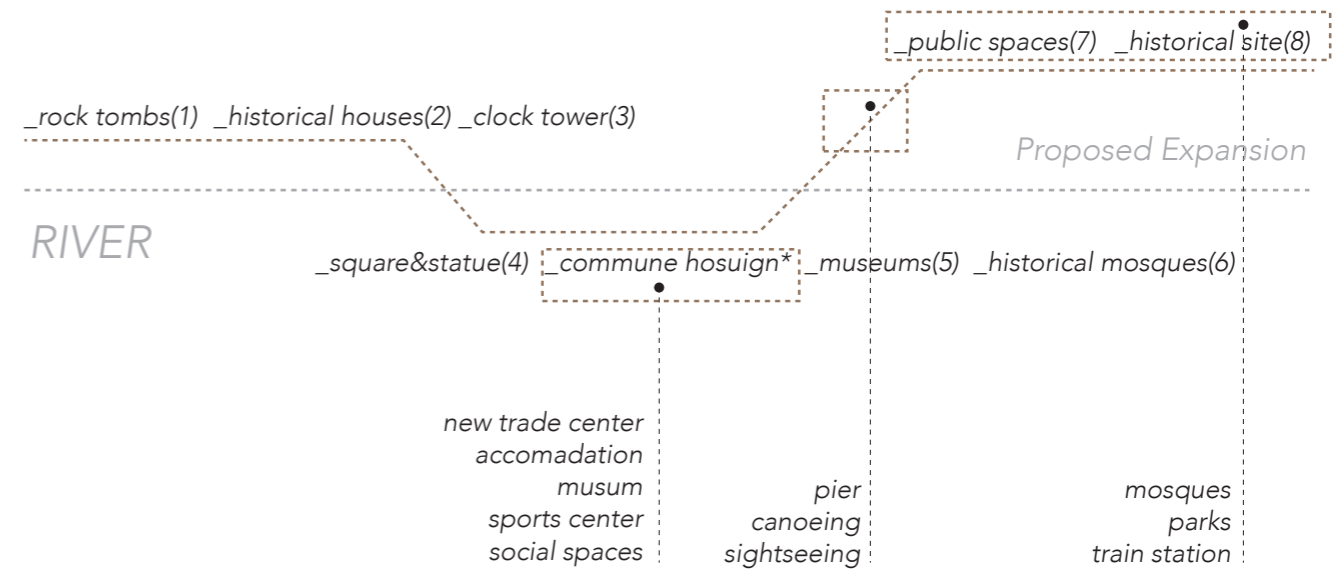

TECTONICS

_PIER
Structure
Circulation
Materialization

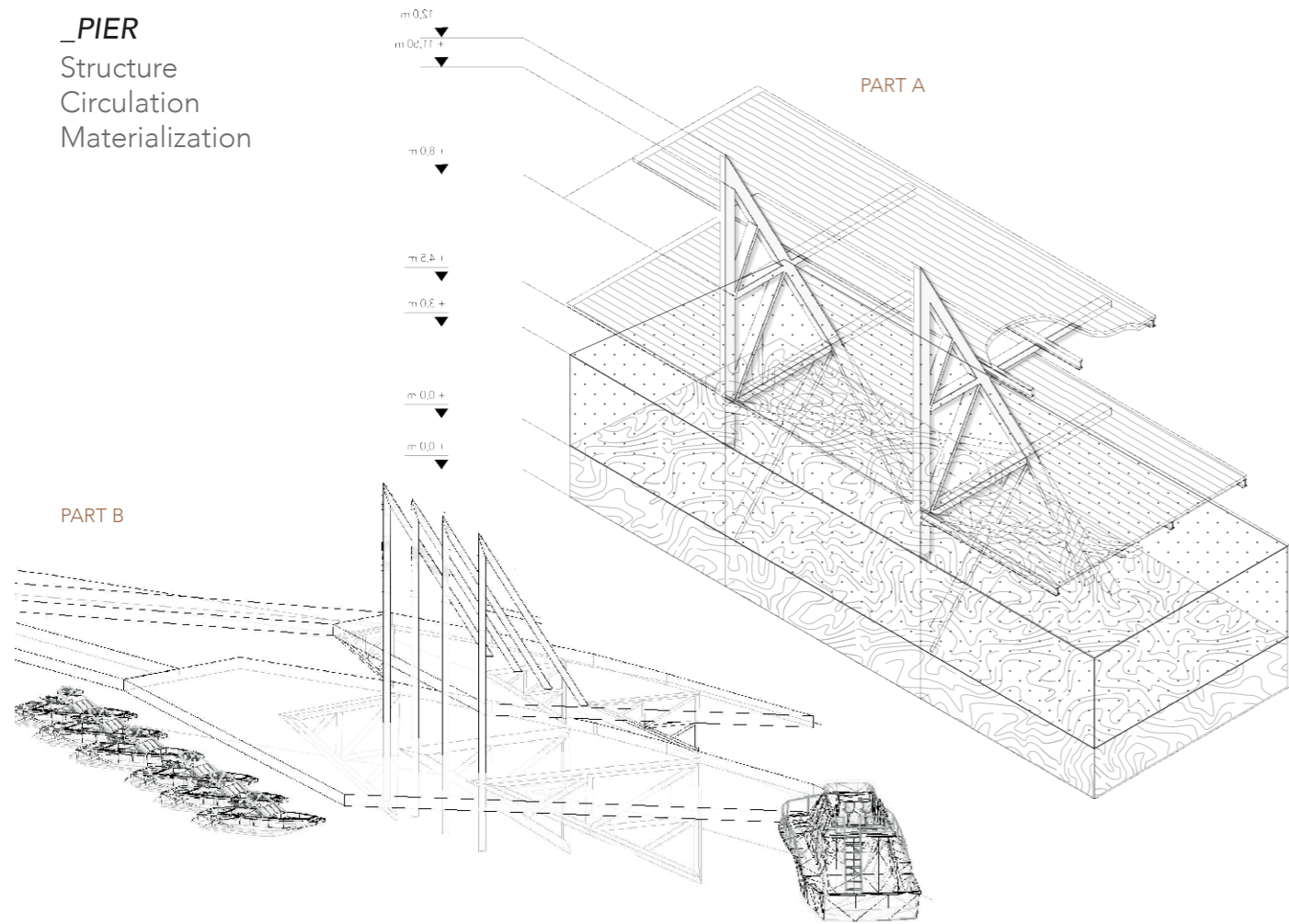

_HOUSING
Circulation
Space Quality

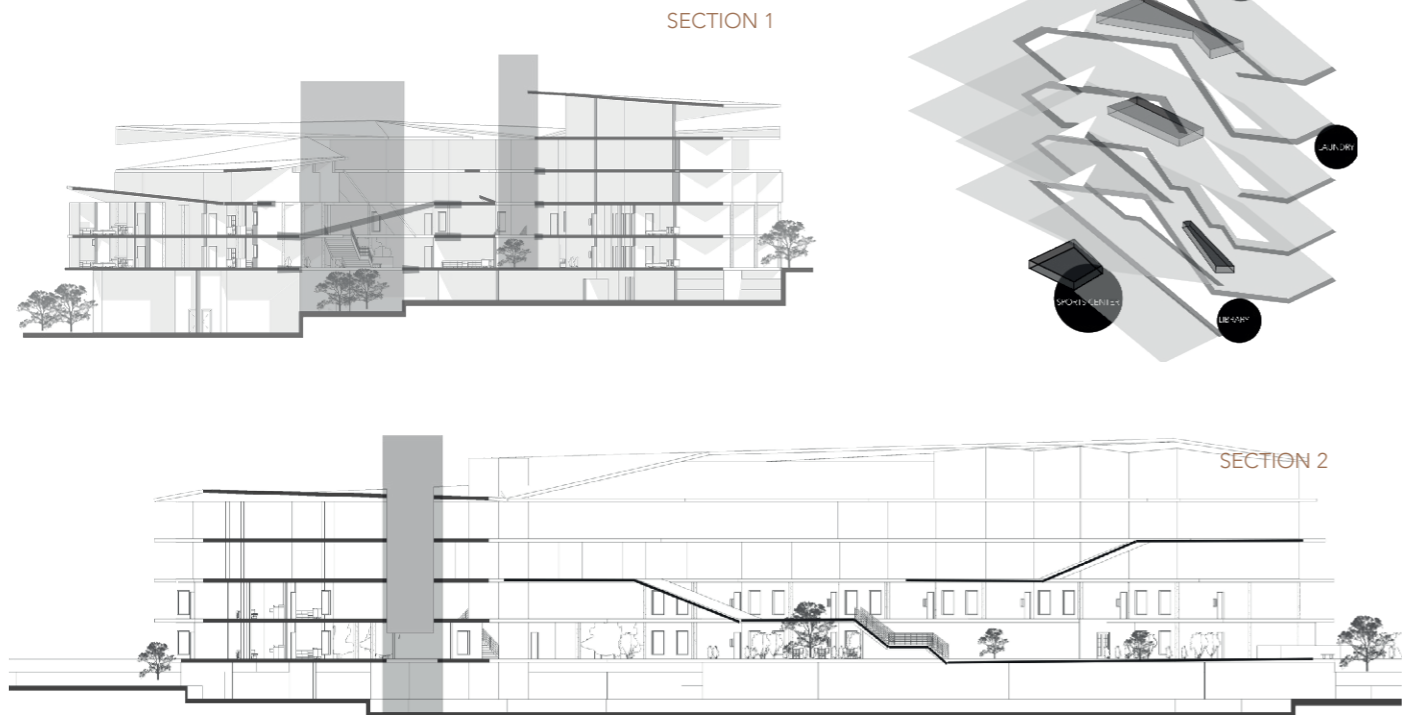

CIRCULATION

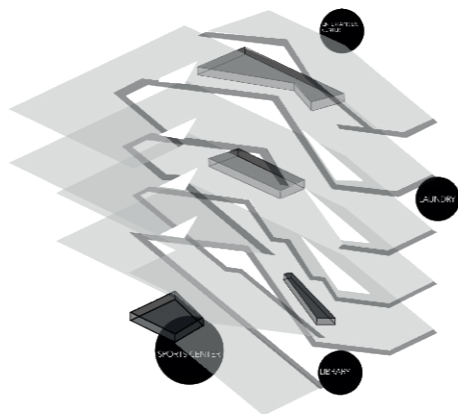

PROGRAM

_FUNCTION
Dimensions

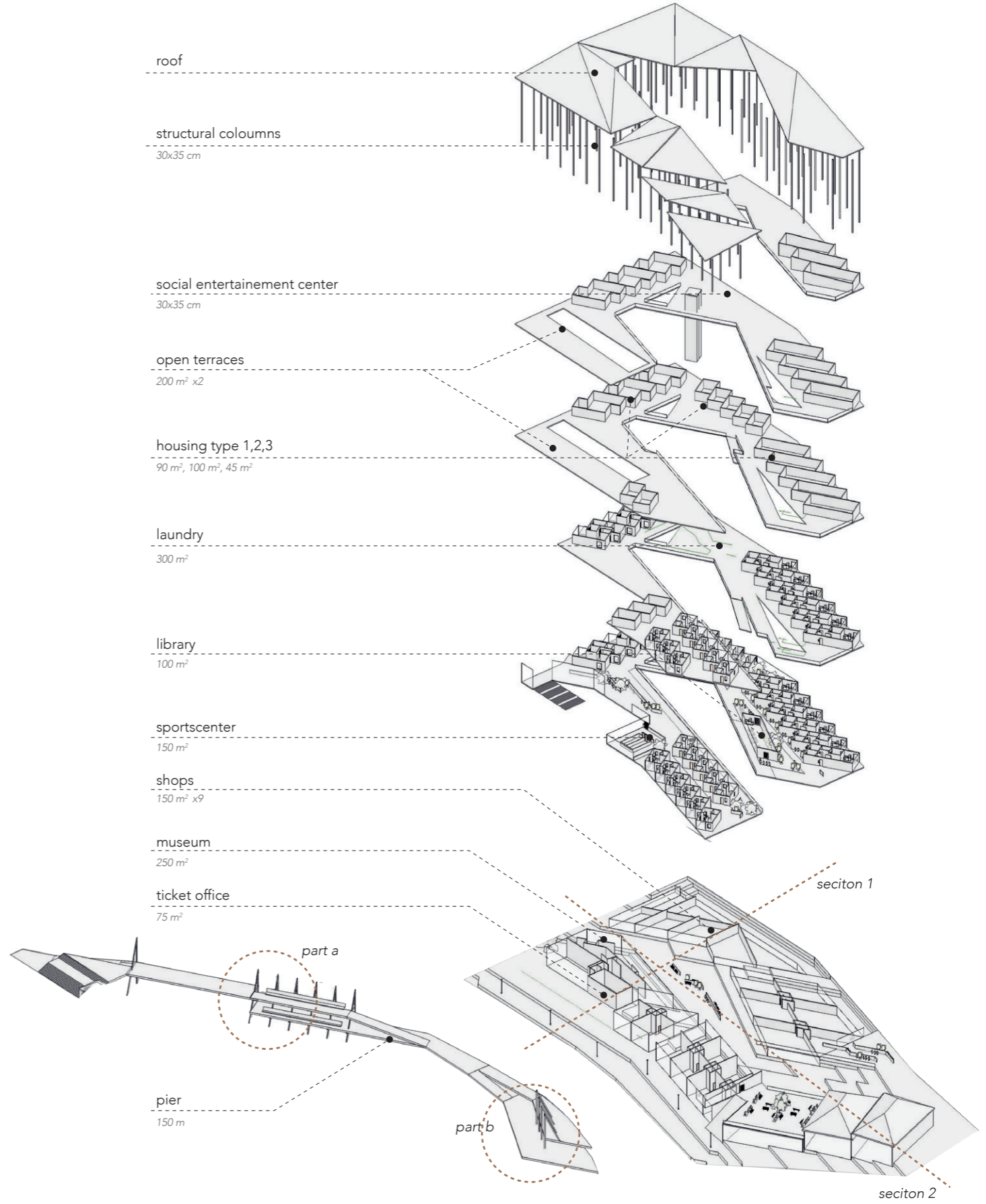

DRAWINGS

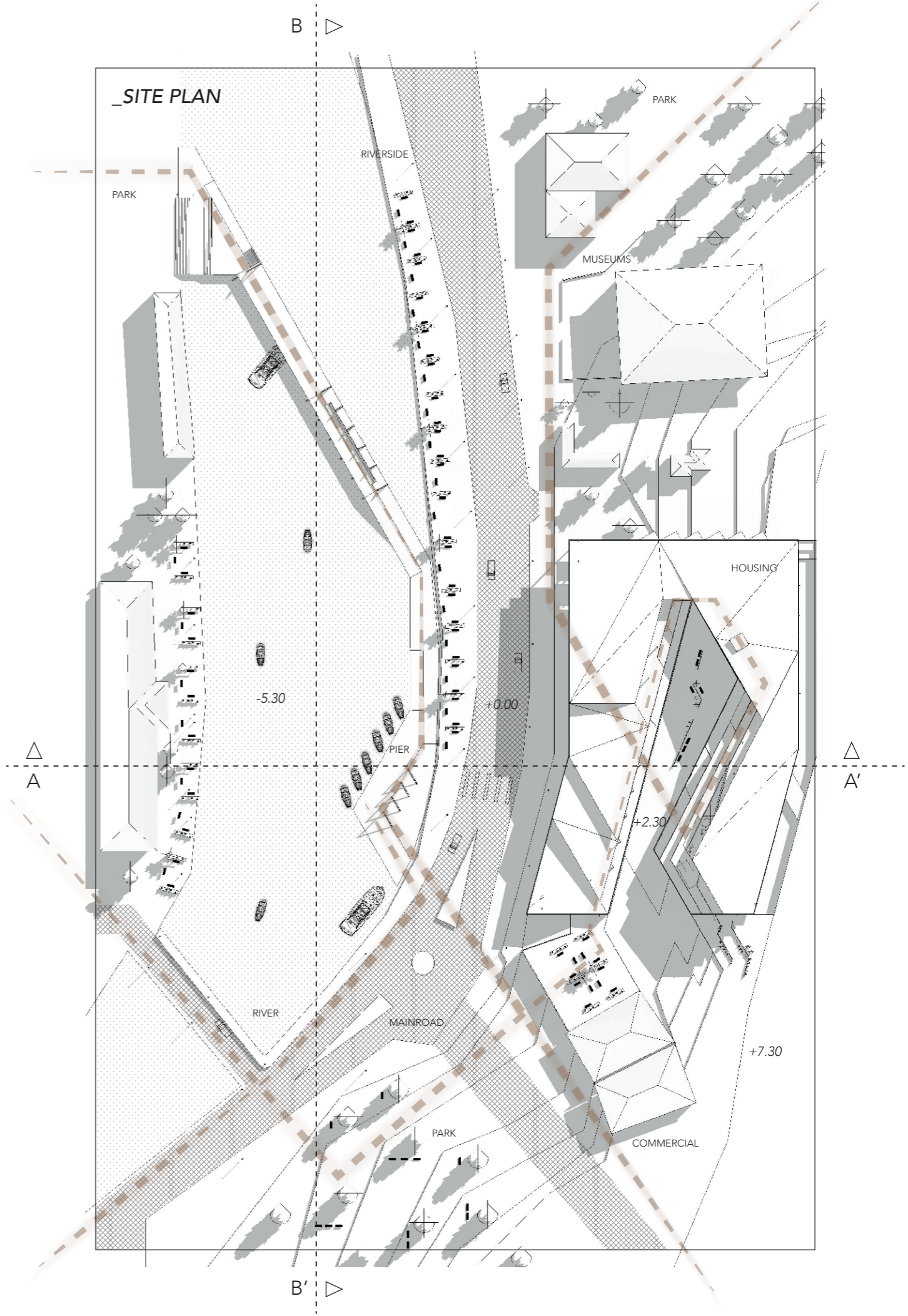
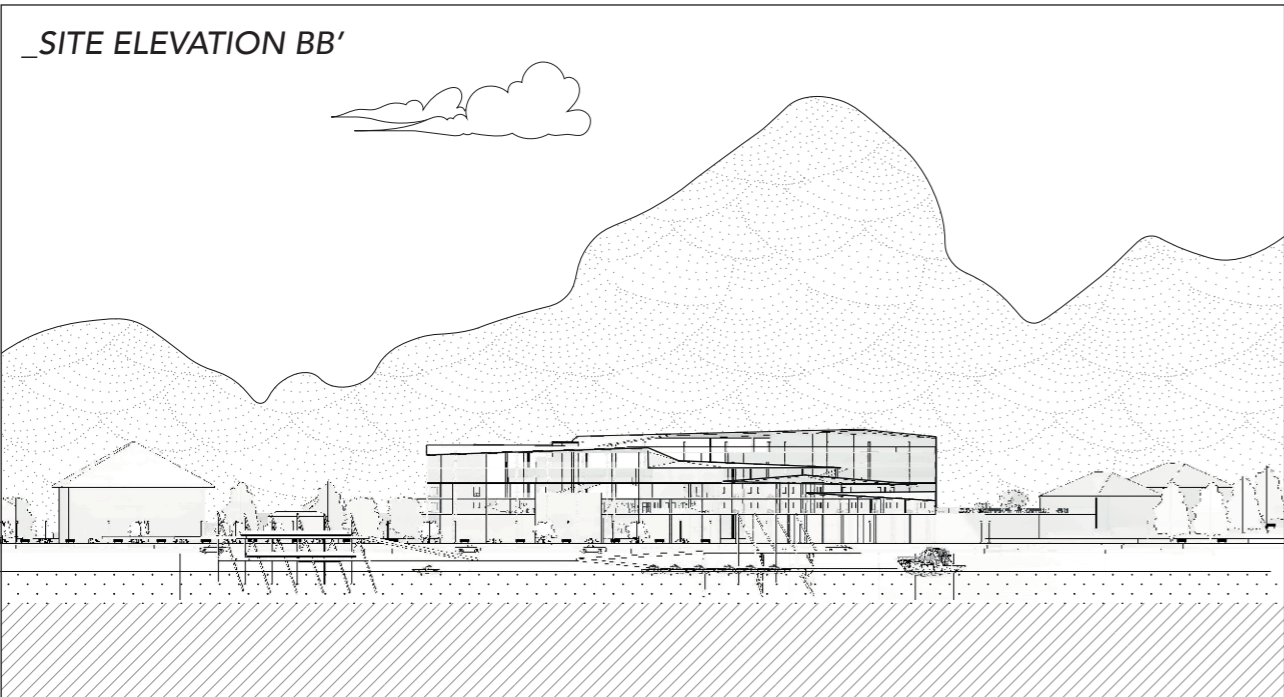
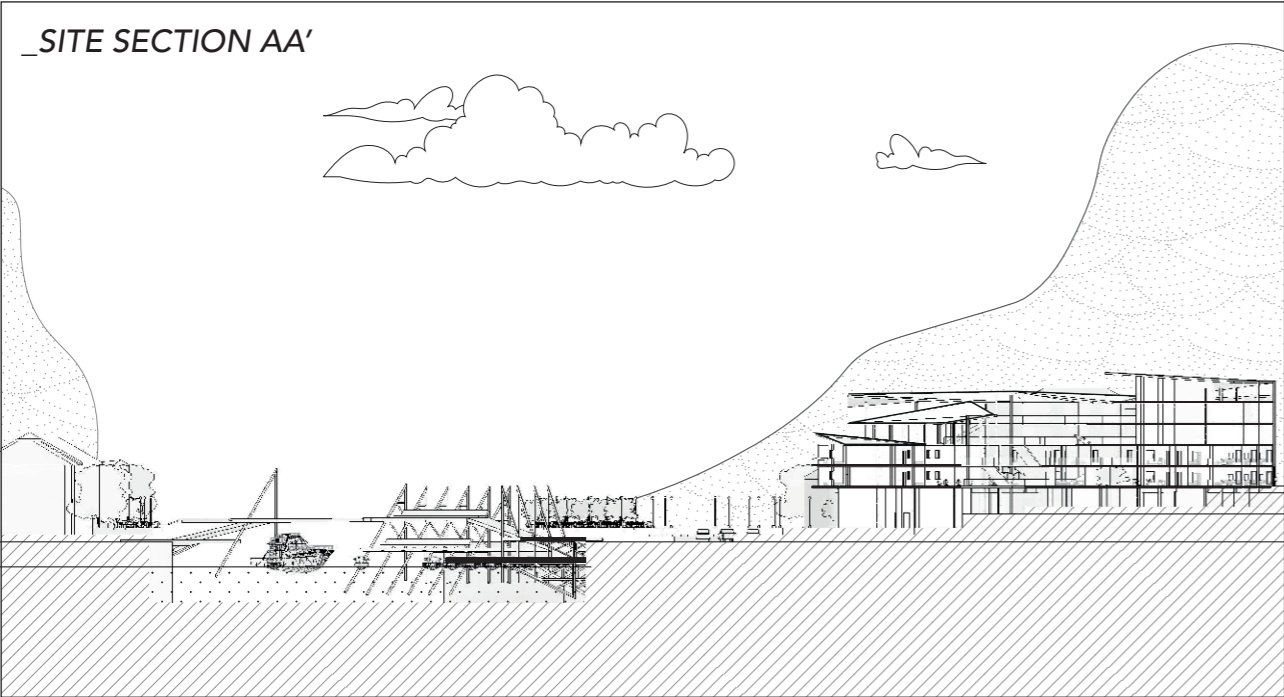

DRAWINGS

_UNIT PLAN TYPOLOGIES

_type1: one person (1+0)

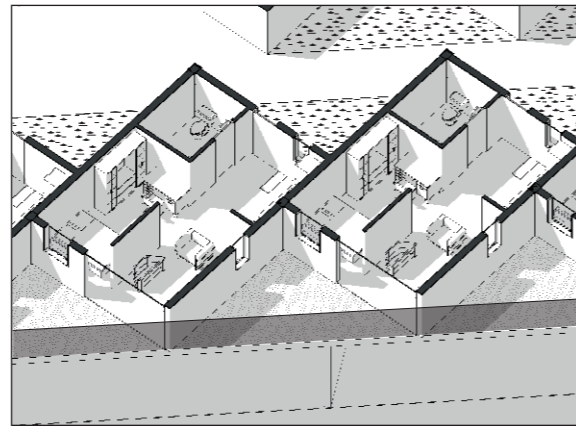
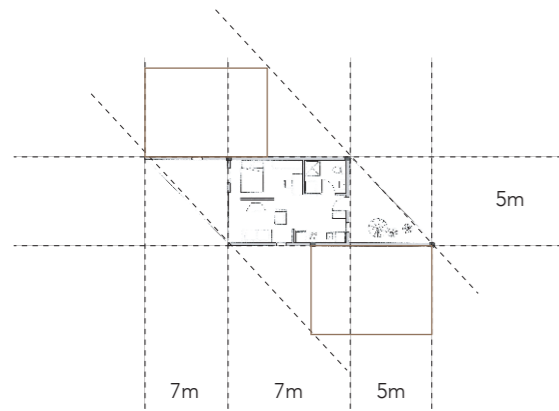

_type2: three or four person (3+1)

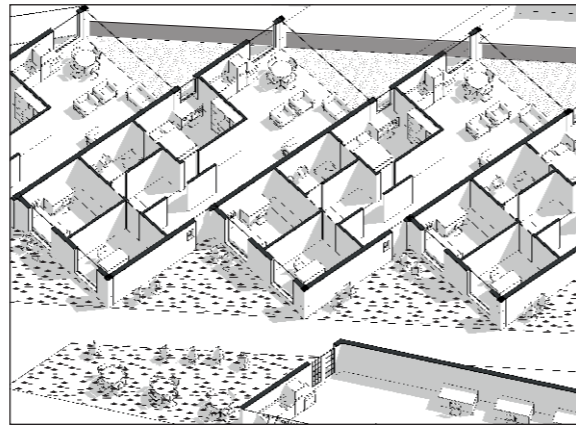
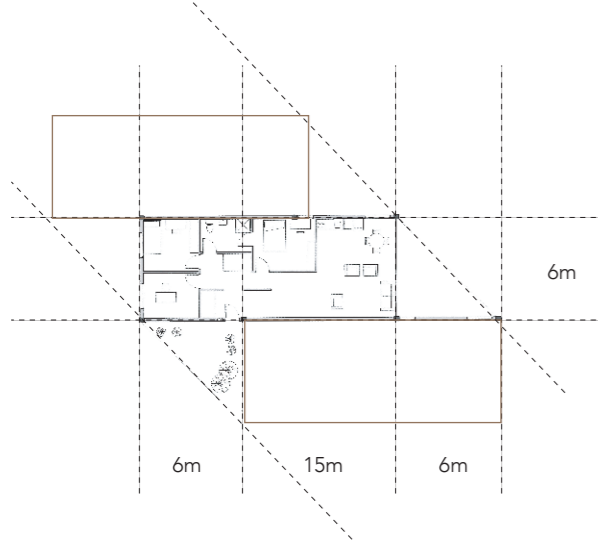

_type2: three or four person (3+1)

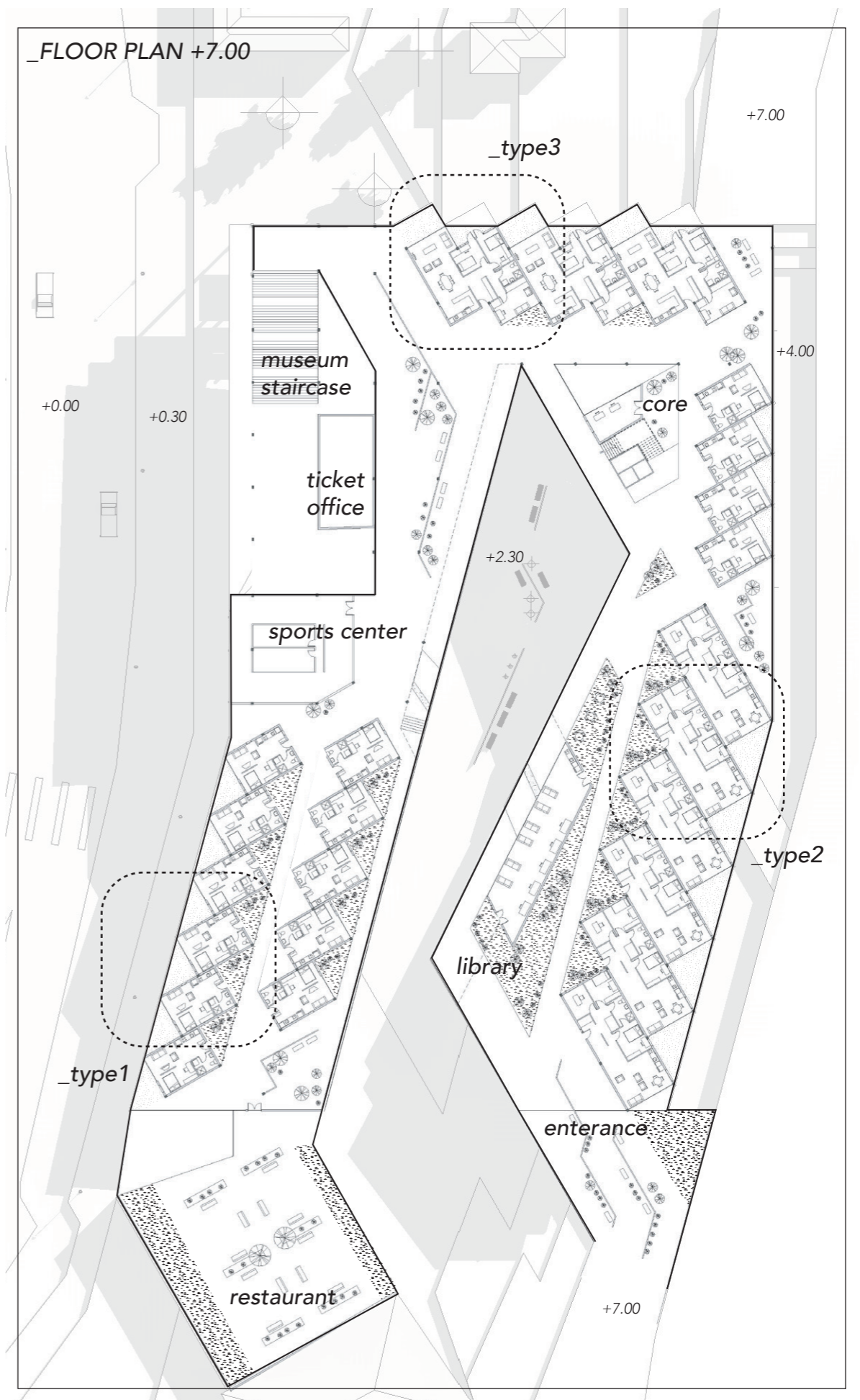
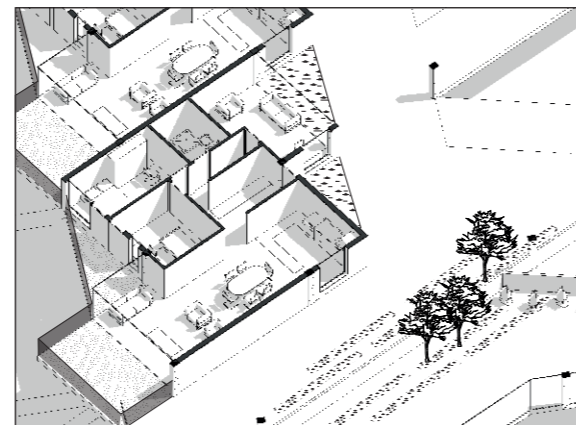
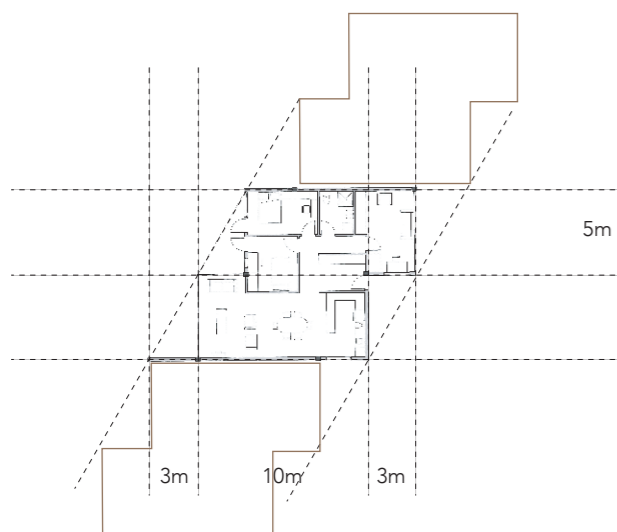

LIFE

_PIER

_HOUSING

_NEW CITY SECTION

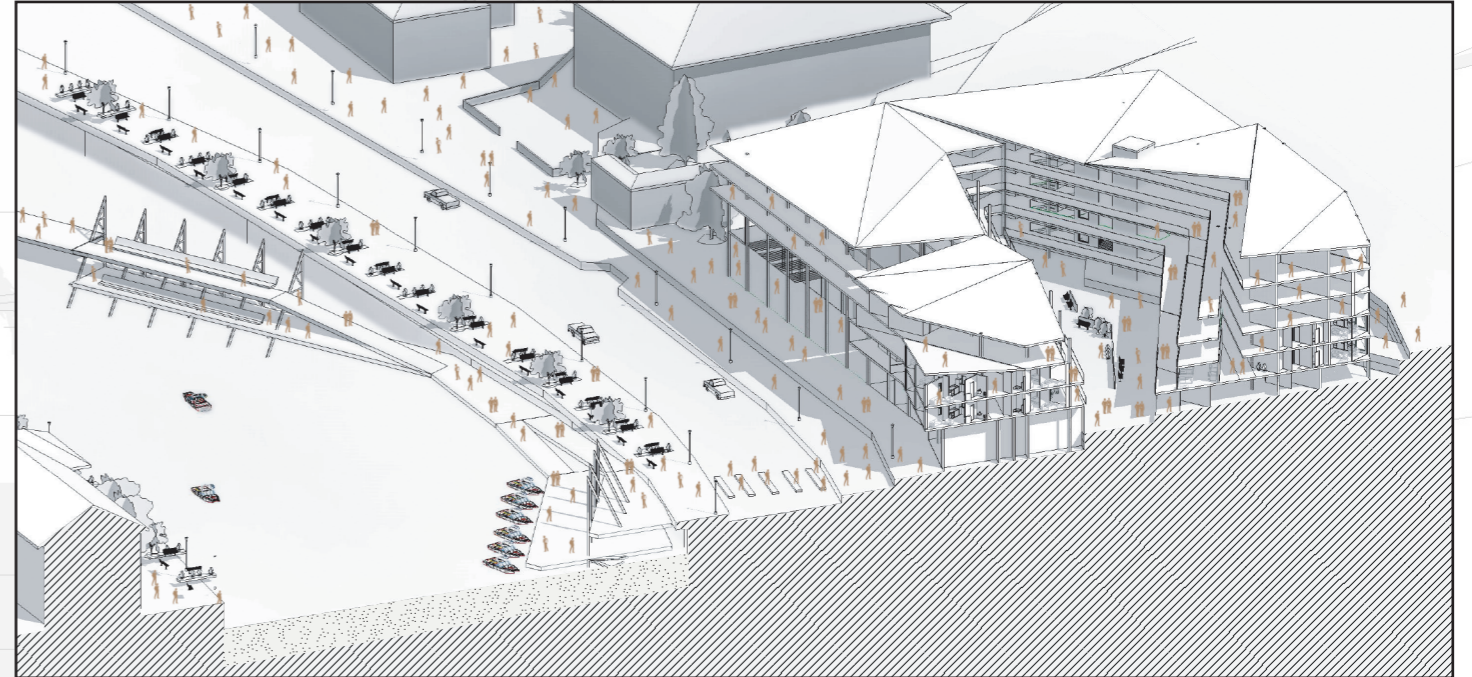
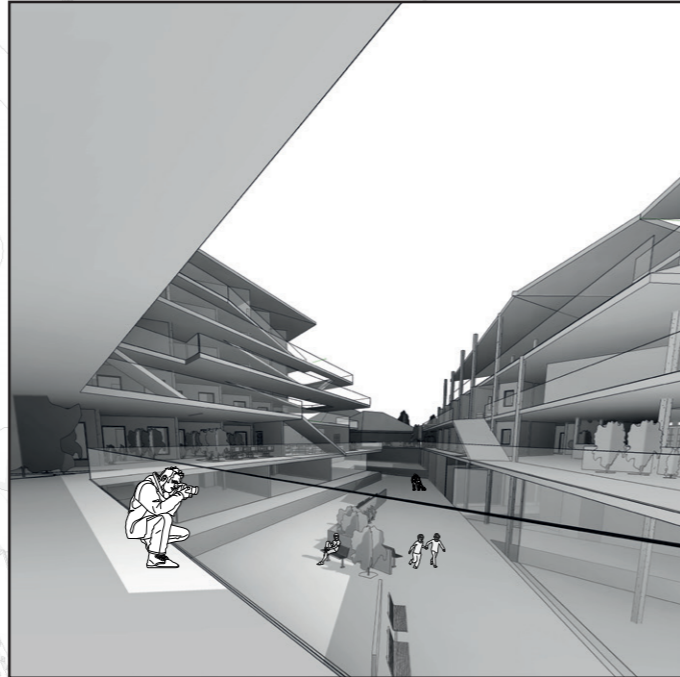
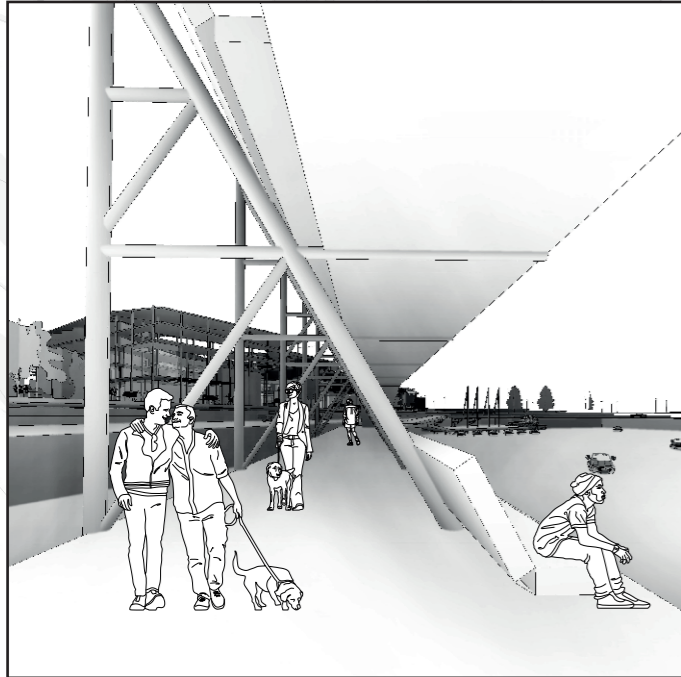

02.C

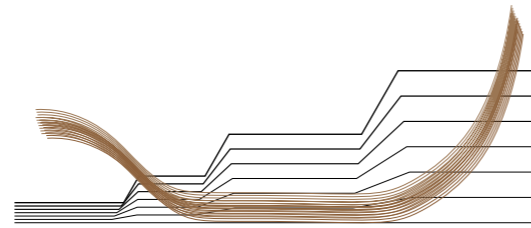

UNDER'fill

Revitalization of Economical Path

SPACE FOR HEALING CITY AND CITIZENS

instructors:

Prof. Dr. Aydan Balamir
Assit. Prof. Dr. Bekir Ay
Ins. Kakri Atabaş

date:

September'16
January'17

location:

Ulus,
Ankara,
TURKEY

Project is dealing with the three main interventions for Ulus (especially triangular site) in terms of crowing Ulus, absence of woman and economical culture-commercial areas.

From past to present, Ulus is the most significant representative of social and cultural fabric for Ankara. As the time passes, city is expanding in accordance with not only determined urbanization principles but also, our own culture, habits. However, Ulus is losing its importance about being center and historic fabric, nowadays. Because of this situation, Ulus, where there is a phenomena related with experienced life and culture of Ankara, should be protected, revitalised, arranged when required, sometimes highlighted.

Can woman become a part of society in Ulus or not? Many researches state that women are the greatest indicator of urban development. Even if it is partially related with the identity of the society, somehow associated with something that comes from the own city characteristics to citizens for proposed life. In fact, architecture, architectural city components, city structure propose a life. Due to architecture, city can be improved and chanced in terms of culture and maybe level of development. In other words, our new architecture understanding responds to social status of women, urban life, culture, existing architecture in our context.

Economic mobility still keeps alive in this site, there is always an observable rush. People are still coming here, living here, working here. There is a culture about economy. Yet, this rush should be controlled and commercial areas should be arranged..

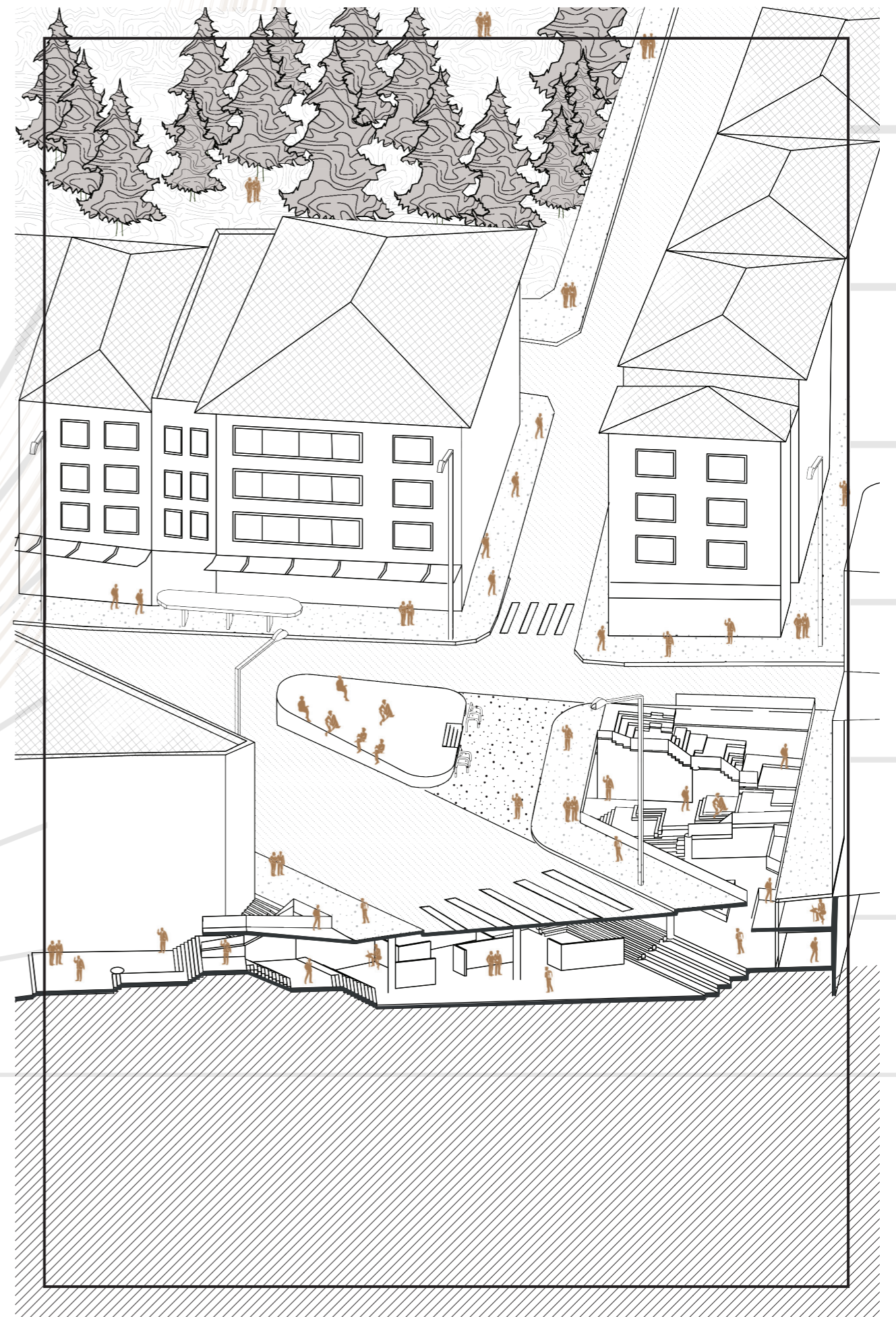

ANALYSIS



HISTORIC CITY CENTER

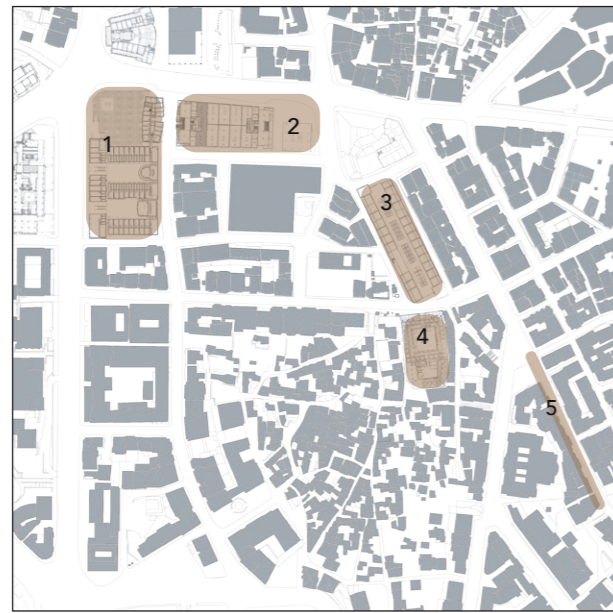

CENTERS OF COMMERCE

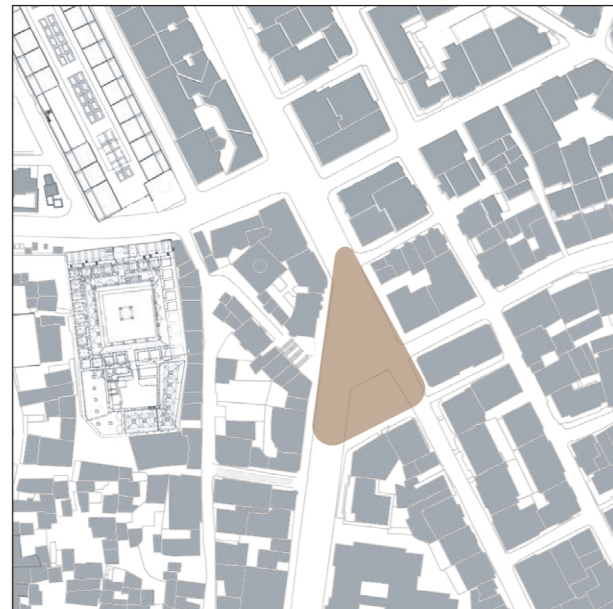

CHOSEN SITE

CONCEPT, PROCESS



_COMMERCE LINE

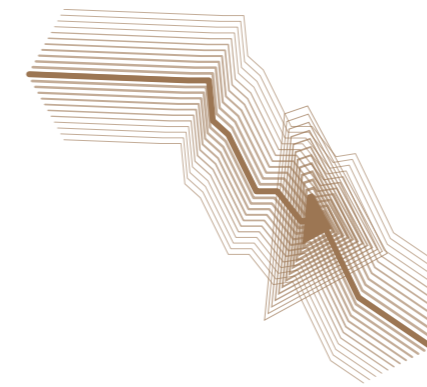

_PROPOSING A NEW CULTURE

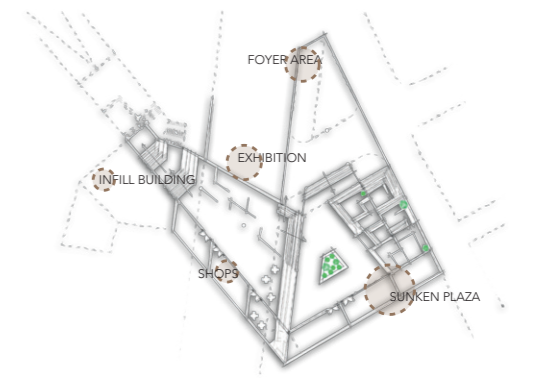

_TO CITIZENS [ESP. WOMAN]
bringing woman to city life

_TO CITY AND CITY LIFE
making alive city center (Ulus)

_TO EXIST ARCHITECTURE
respecting and highlighting valuable ones

_TO ECONOMY
healing the commerce culture in Ulus

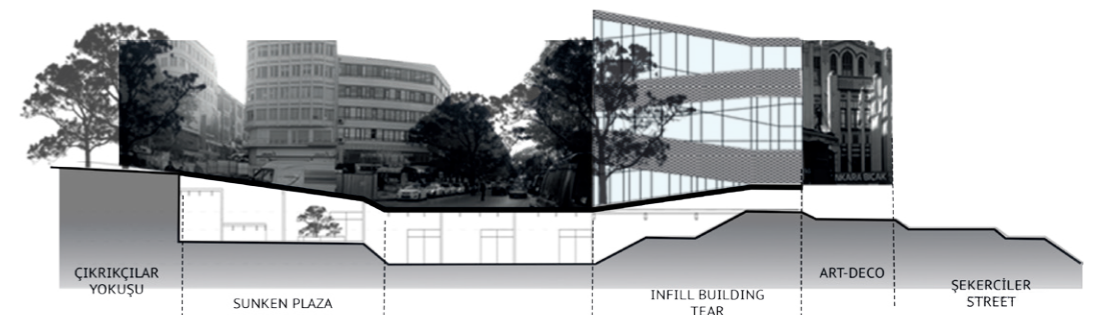

PROGRAM

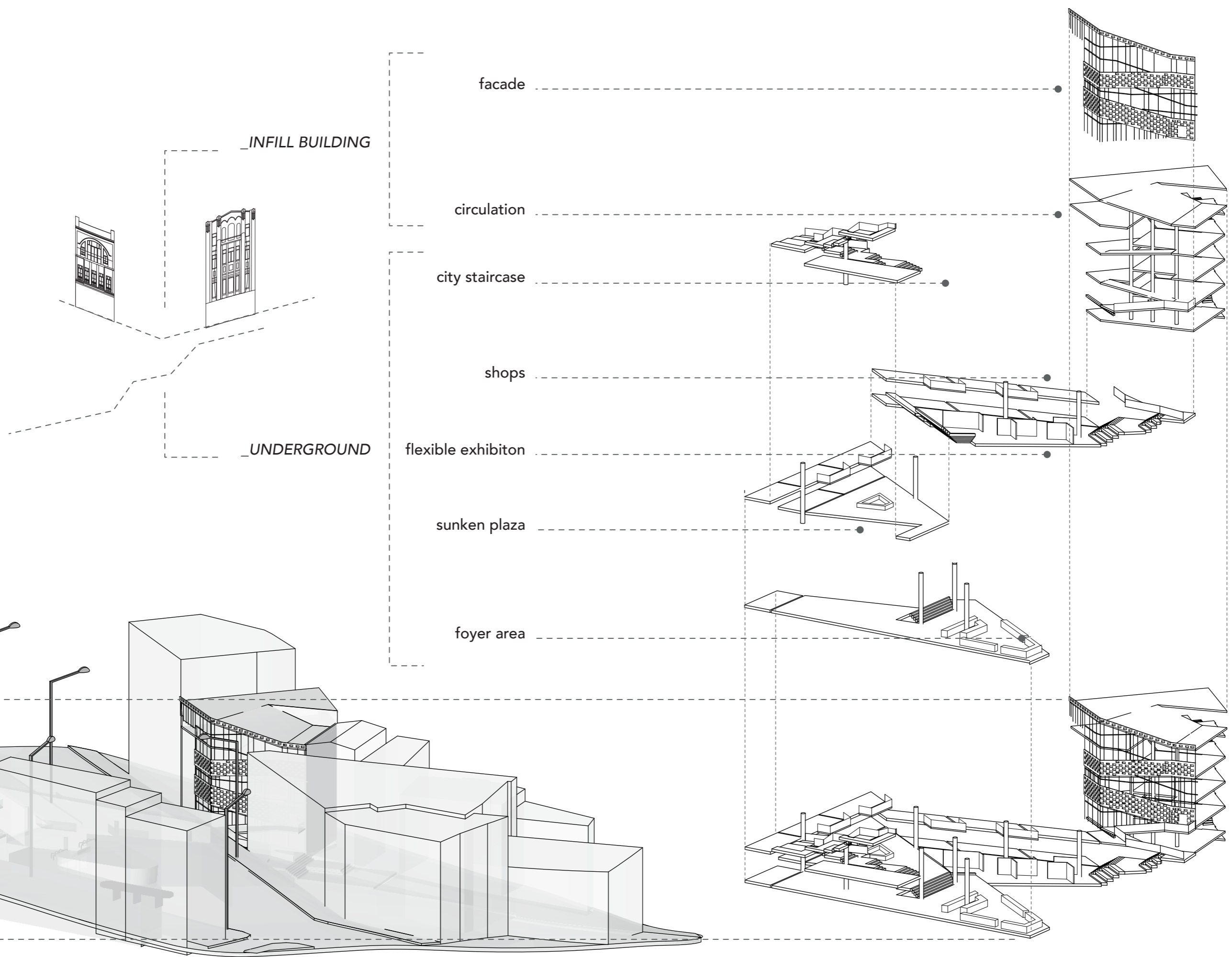

TECHNICAL DRAWING

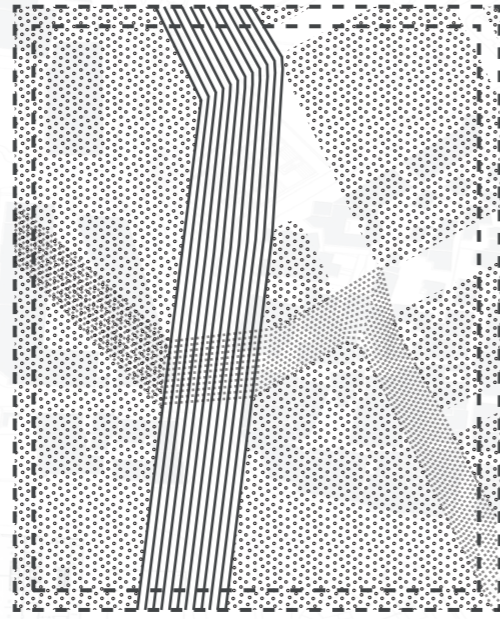

_STREET LEVEL PLAN

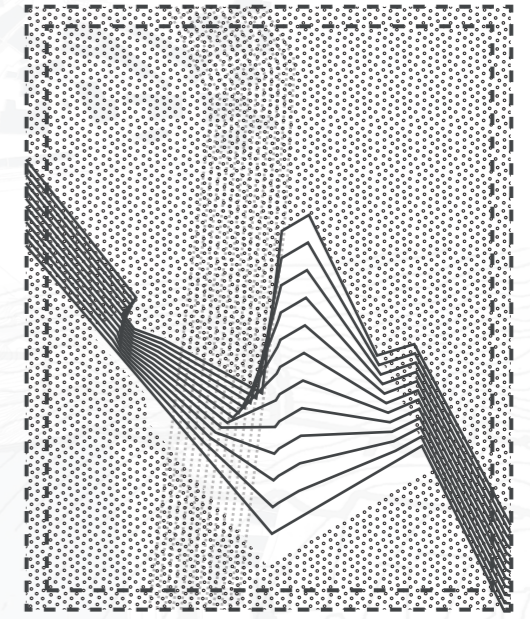

_UNDERGROUND PLAN

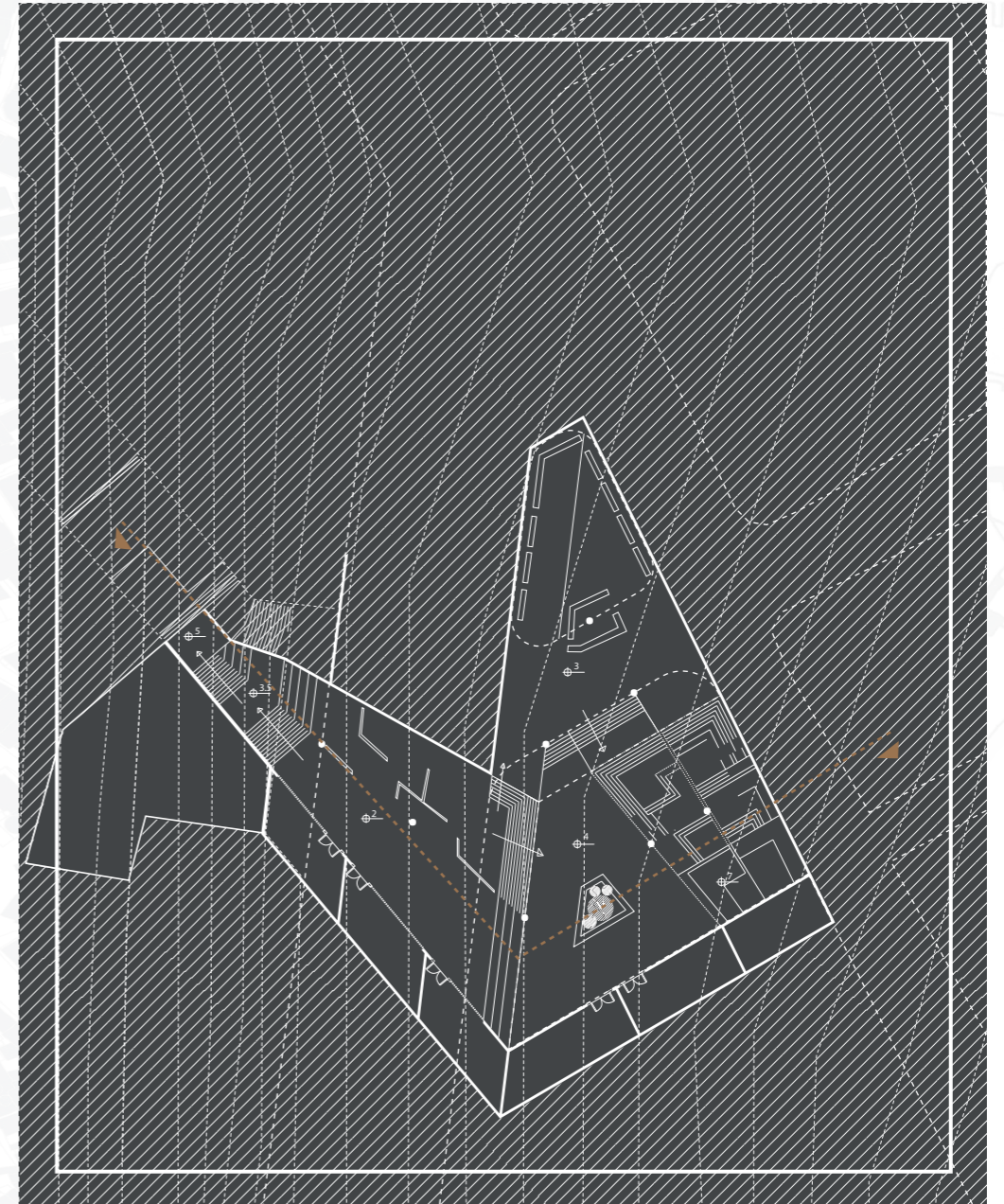
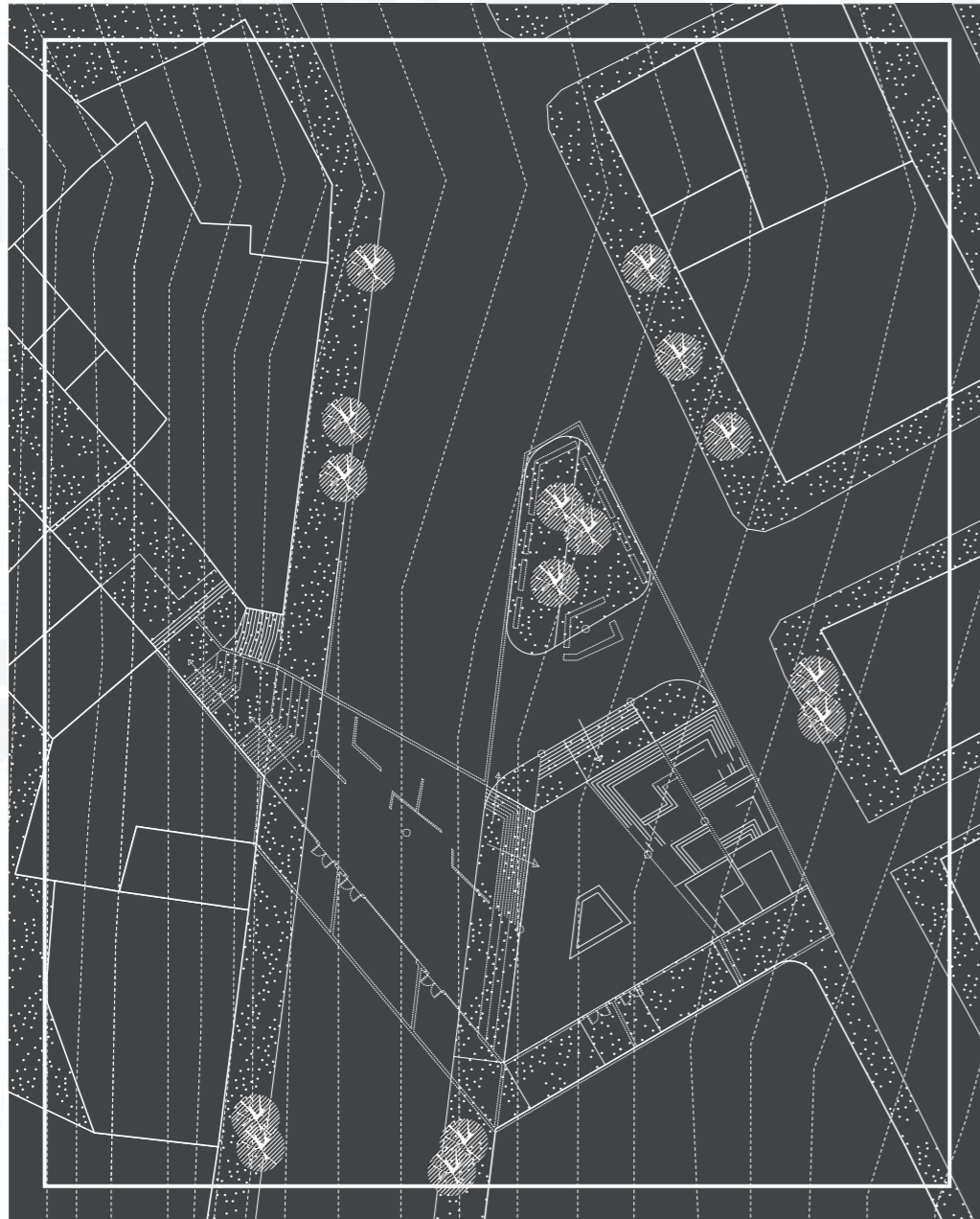

TECHNICAL DRAWINGS

ELEVATION OF INFILL BUILDING

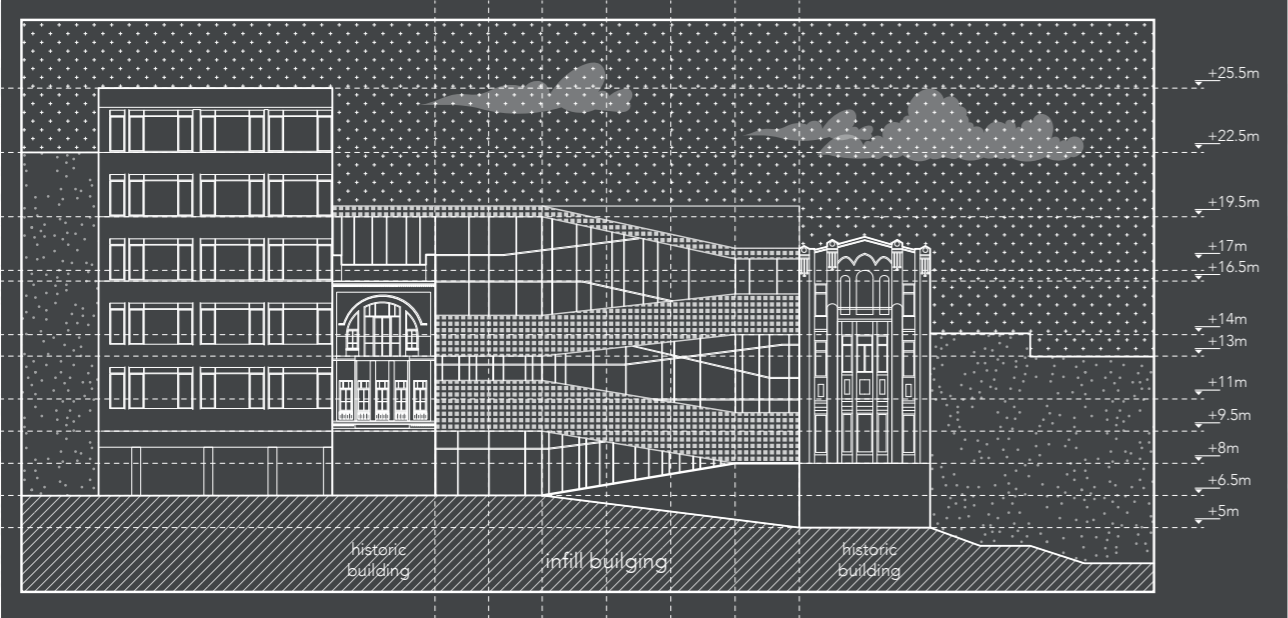

CITY SECTION AA'

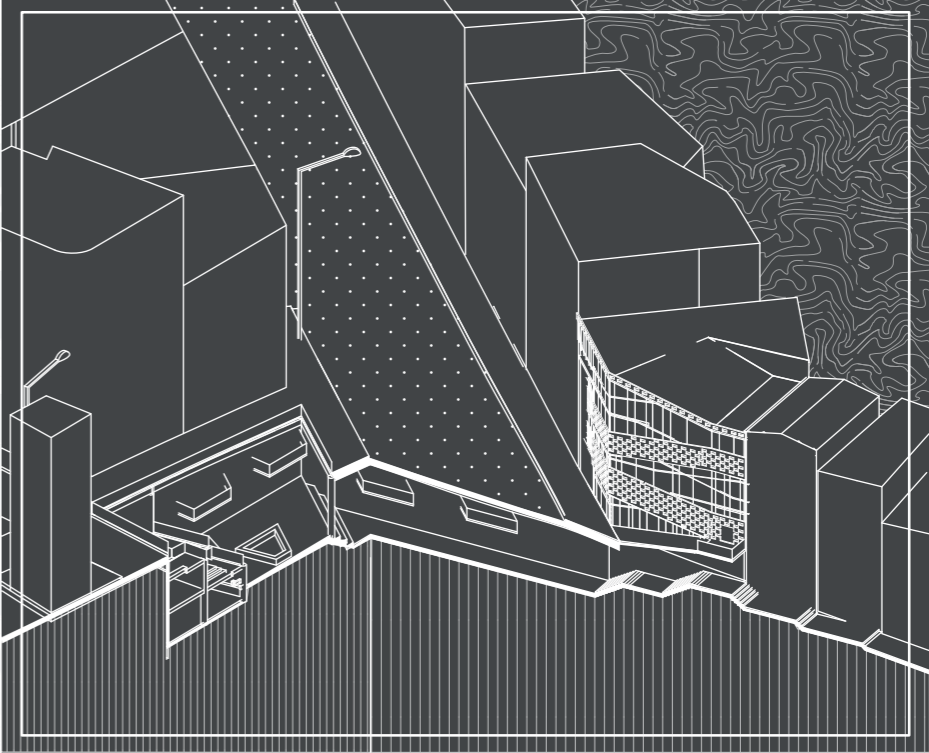

+5.00 PLAN

+8.00 PLAN

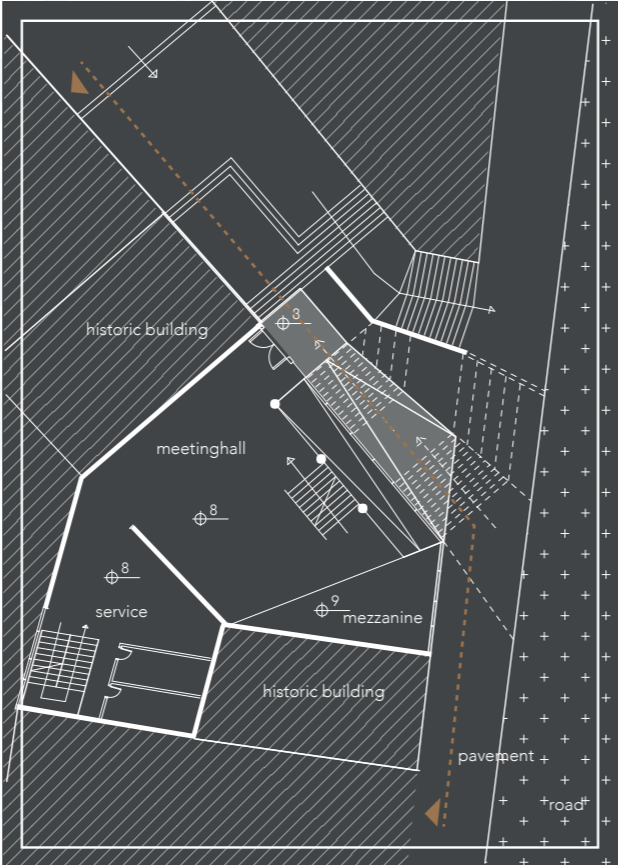
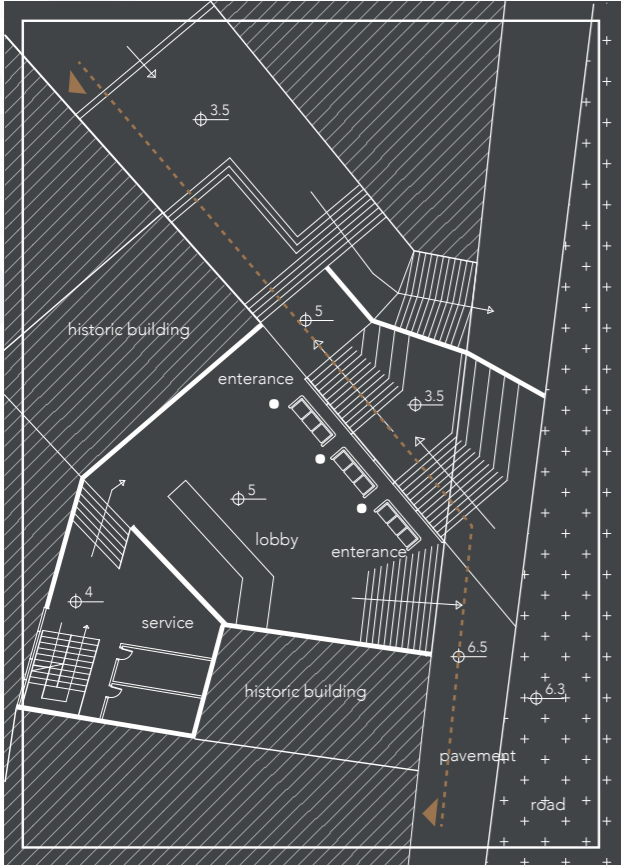

CITY SECTION BB'

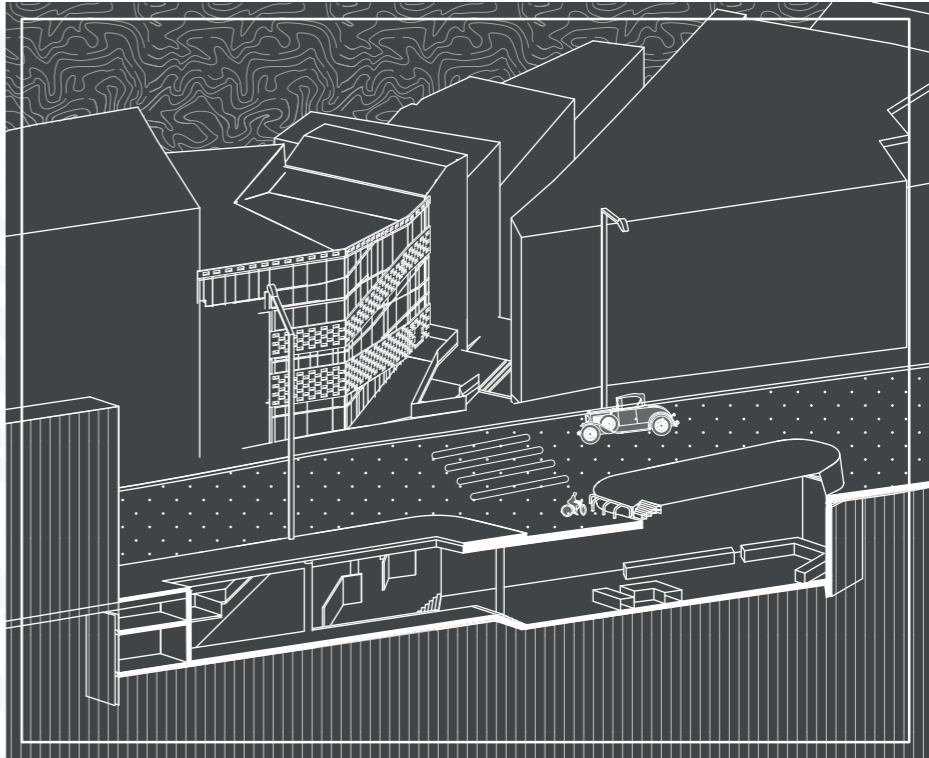



_SUNKEN PLAZA
_FOYER AREA
_EXHIBITION



_INFILL BUILDING
_HISTORIC MARKET PLACE
_ENTRANCE OF UNDERGROUND